

Dimmer

113479, 113480

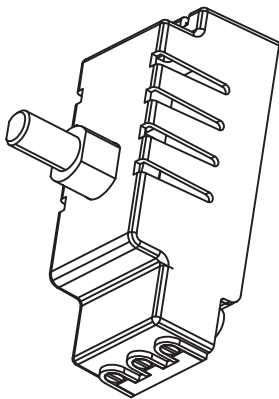

Thank you for purchasing this unit. Please read the instructions carefully before use to ensure safe and satisfactory operation of this product. Please retain these instructions for future reference.

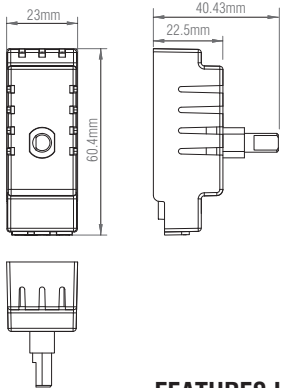

WARNINGS:



HAZARD OF ELECTRIC SHOCK AND ARC FLASH

- It is illegal for persons other than an appropriately licensed electrical contractors or other persons authorised by legislation to work on the fixed wiring of any electrical installation.
- To comply with all safety standards, the product must be used only for the purpose described in this instruction and must be installed in accordance with the wiring rules and regulation in the location where it is installed.
- There are no user serviceable parts inside the product.

Failure to follow these instructions will result in death or serious injury.



RISK OF ELECTRIC SHOCK

- Hazardous voltage and electrical current may be present at the wire leads of this product even when the device is switched off.
- Lock out and tag the input circuit before accessing the wiring connections.



EQUIPMENT DAMAGE HAZARD

- Install the device according to instructions in this document.
- Pay attention to the specifications and wiring diagrams related to the installation.
- Do not use this product for any other purpose than specified in this instruction.
- Two or more dimmers cannot be connected in parallel or series to control the same load from two different locations.
- The product is suitable for indoor use only.
- Apply IEC60898-1 compliant 250V 6A type C MCB as overload protection.

FEATURES INCLUDE:

- Complies with IEC Safety and EMC Standards.
- Full short circuit protection.
- Inbuilt over-current protection.
- Supports dimming of two loads individually.
- Compatible with dimmable LED lamps.

LOAD CAPABILITY:

Load Symbol	Compatible Loads	Maximum Loads		Minimum Loads
		113479	113480	
	Dimmable LED Lighting	100W	250W	2W
	Incandescent Lighting, 240V Halogen Lamps	200W	400W	2W
	Low Voltage Halogen Lighting with Electronic Transformers	100VA	300VA	2VA

TECHNICAL SPECIFICATIONS:

Nominal Operating Voltage		240 V ac
Nominal Operating Frequency		50 Hz
Maximum Load	113479	100 VA @1 Gang
	113480	400 VA @1 Gang
Minimum Load		2VA
Dimming Technique		Trailing edge Phase Control
Mounting Centres		Comply with BS1363 standard wall panel
Compliance		IEC 60669-2-1

INSTALLATION

1. Switch off the mains supply before commencing the installation.
2. Wire block according to wiring diagram. Secure Dimmer to wall with 2 screws and insert 2 screw covers over holes on front plate.
3. Minimum brightness is adjustable by rotating the screw on the back of dimmer until it reaches desired minimum brightness level without flickering.

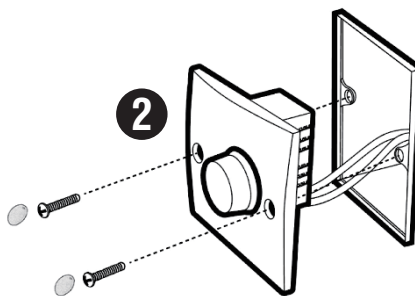
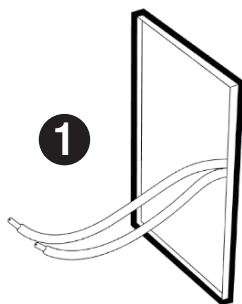

WIRING & OPERATION

A Connect to single load

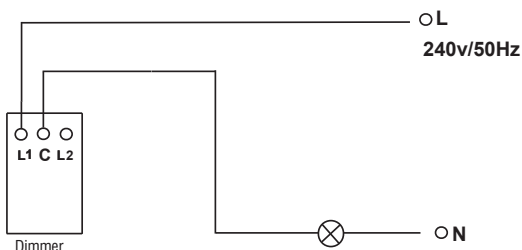

A Single load operation

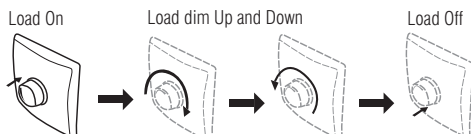

B Connect to double loads

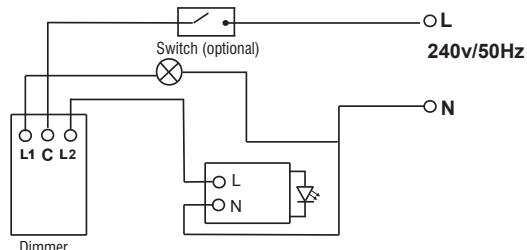

B Double load operation

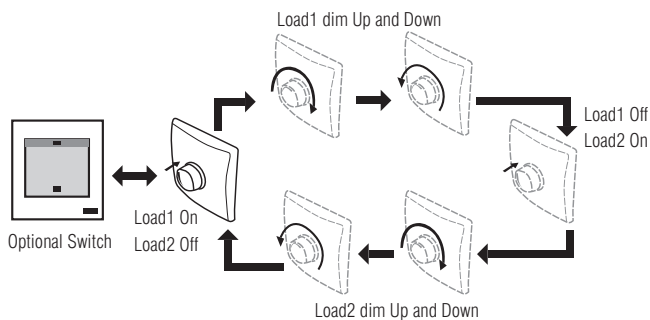

Minimum Settings:

Push ON the lamp. turn to Min. position then turn to Max. position. Repeat the operation Min to Max. position for 7 times. Lamp will appear flashing 3 times. Then set your desire min. level, push OFF and push ON to save the setting.



Conformity with all relevant UKCA Directive requirements.



Conformity with all relevant EC Directive requirements.



Waste electrical products should not be disposed of with household waste. Please recycle where facilities exist. Check with your Local Authority or local store for recycling advice.



This product is not a toy. Keep away from children and animals.



Do not expose this product to moisture, water or other liquids.



Do not attempt to examine or repair this product yourself.



This product is designed for indoor use only. Do not use outside!