



WKC 10kA MCB

Function

- Protection of circuits against short-circuit currents;
- Protection of circuits against overload currents;
- Switch;
- Isolation

Selection

Technical data of the network at the point considered: the earthing systems (TNS, TNC), short-circuit current at the circuit-breaker installation point, which must always be less than the breaking capacity of this device, network normal voltage.

Tripping curves:

B curve (3-5In)---protection for people and big length cables in TN and IT systems.

C curve (5-10In)---protection for resistive and inductive loads with low inrush current

D curve (10-14In)---protection for circuits which supply loads with high inrush current at the circuit closing (LV/LV transformers, breakdown lamps)

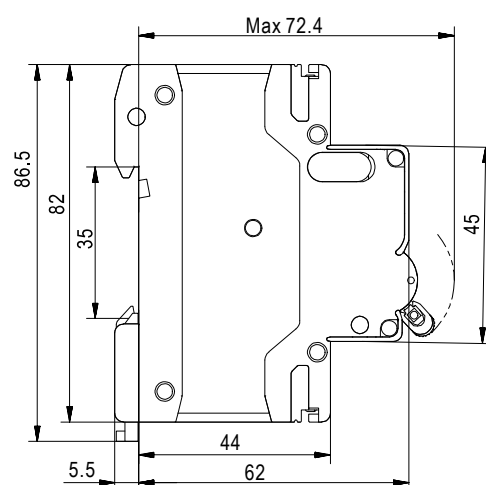

| Part No. | Discription |
|----------|--------------------------------|
| WKC1**B | 1 Pole 10kA MCB 6A-63A B curve |
| WKC2**B | 2 Pole 10kA MCB 6A-63A B curve |
| WKC3**B | 3 Pole 10kA MCB 6A-63A B curve |
| WKC4**B | 4 Pole 10kA MCB 6A-63A B curve |
| WKC1**C | 1 Pole 10kA MCB 6A-63A C curve |
| WKC2**C | 2 Pole 10kA MCB 6A-63A C curve |
| WKC3**C | 3 Pole 10kA MCB 6A-63A C curve |
| WKC4**C | 4 Pole 10kA MCB 6A-63A C curve |
| WKC1**D | 1 Pole 10kA MCB 6A-63A D curve |
| WKC2**D | 2 Pole 10kA MCB 6A-63A D curve |
| WKC3**D | 3 Pole 10kA MCB 6A-63A D curve |
| WKC4**D | 4 Pole 10kA MCB 6A-63A D curve |

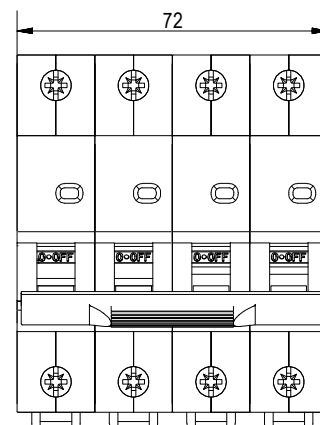
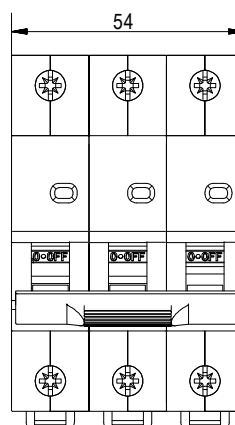
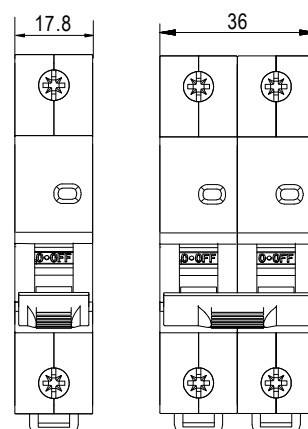
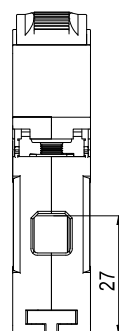



Technical Data

| Product code | WKS | |
|------------------------------|---|--------------------------------------|
| Electrical features | Standard | IEC 60898-1, BS EN 60898-1 |
| | Rated current I_n (A) | 1,2,3,4,6,10,16,20,25,32,40,50,63,80 |
| | Poles | 1P, 2P, 3P, 4P |
| | Rated voltage U_e (V) | 230/400~ 240/415 |
| | Insulation voltage U_i (V) | 500 |
| | Rated frequency | 50/60Hz |
| | Rated breaking capacity | 10 kA |
| | Energy limiting class | 3 |
| | Rated impulse withstand voltage (1.2/50) U_{imp} (V) | 4000 |
| | Dielectric test voltage at ind. Freq. for 1 min (kV) | 2 |
| | Pollution degree | 2 |
| | Power loss per pole | Rated current (A) |
| | | 1,2,3,4,6,10,16,20,25,32,40,50,63,80 |
| | Thermo-magnetic release characteristic | B, C, D |
| Mechanical features | Electrical life | 4,000 |
| | Mechanical life | 20,000 |
| | Contact position indicator | Yes |
| | Protection degree | IP 20 |
| | Reference temperature for setting of thermal element (°C) | 30 |
| | Ambient temperature (with daily average $\leq 35^\circ\text{C}$) | -5...+40 °C |
| | Storage temperature (°C) | -25. . . +70 °C |
| Installation | Terminal connection type | Cable/U-type busbar/Pin-type busbar |
| | Terminal size top/bottom for cable | 25mm ² / 18-4 AWG |
| | Terminal size top/bottom for busbar | 10mm ² / 18-8 AWG |
| | Tightening torque | 2.5 N*m / 22 In-lbs. |
| | Mounting | On DIN rail EN 60715 (35mm) |
| | Connection | From top and bottom |
| Combination with accessories | Auxiliary contact | Yes |
| | Shunt release | Yes |
| | Under voltage release | Yes |
| | Alarm contact | Yes |

