

LOOX 12V LED 2047 DOWNLIGHT

The powerful LED 2047 with frosted real glass cover makes a wide range of applications possible in furniture. The housing components are exclusively made from steel, providing good service as ambient lighting for years. The different mounting variants and optional housing provide a great deal of flexibility during installation.

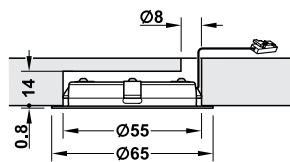

Loox 12V LED 2047 downlight, Ø 65 mm



ARTICLES REMOVED FROM PAGE
 833.71.781 replaced by new product 833.88.763
 833.71.782 replaced by new product 833.88.764
 833.71.783 replaced by new product 833.88.762
 833.71.784 replaced by new product 833.88.761

Distance	120°	3000 K	4000 K	5000 K
250 mm		560 Lx	570 Lx	670 Lx
500 mm		210 Lx	215 Lx	245 Lx
750 mm		115 Lx	115 Lx	135 Lx
1000 mm		75 Lx	75 Lx	90 Lx



Order bezel separately for surface mounting

- > 0.8 mm rim, min. 14 mm hole depth required
- > For recess mounting, press-fit in Ø 55 mm hole, order bezel separately
- > For surface mounting, order bezel separately
- > Voltage: 12V. Wattage: 3.0W
- > Dimmable
- > Degree of protection: IP20
- > With 2 m lead with Loox 12V connector
- > Steel housing
- > Order qty: 1 pc or set

Output:	3000 K	4000 K	5000 K
Light colour:	Warm white	Cool white	Cool white
Wattage (W):	3	3	3
Energy efficiency:			
Number of diodes	24	24	24
Light output (Lm):	210	216	240
Efficacy (Lm/W):	70	72	80
Colour Rendering Index:	90	90	83

12V 0-100%

Finish	3000 K	4000 K	5000 K
Polished chrome-plated	833.72.300	833.72.301	833.72.302
Silver coloured	833.72.340	833.72.341	833.72.342
Stainless steel coloured	833.72.390	833.72.391	833.72.392
Set includes 3 surface mounted lights with bezels, mains lead and driver			
Polished chrome-plated	833.88.763	833.88.764	-
Stainless steel coloured	833.88.762	833.88.761	-

Loox 12V LED 2047 bezel, Ø 66.5 mm

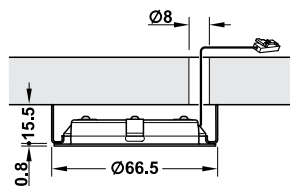

- > For surface mounting Loox LED 2047 downlight
- > Screw fixing
- > Zinc alloy
- > Order qty: 1 pc



Finish	Cat. No.
Polished chrome	833.72.802
Silver coloured	833.72.803
Stainless steel coloured	833.72.804

YOU ALSO NEED:

DRIVER
Page 5.74

SWITCH
Page 5.79-86

OPTIONAL ACCESSORIES
Pages 5.75, 5.78