

Wiring

• This product is double insulated and must not be earthed. If there are any incoming earth cables, they must be joined together and well insulated with good quality insulation tape. This is to ensure earth continuity throughout your property.

• Having correctly identified the wiring from your existing light fitting, connect to the quick fit connection block in the following way, using the supplied link cables where necessary.

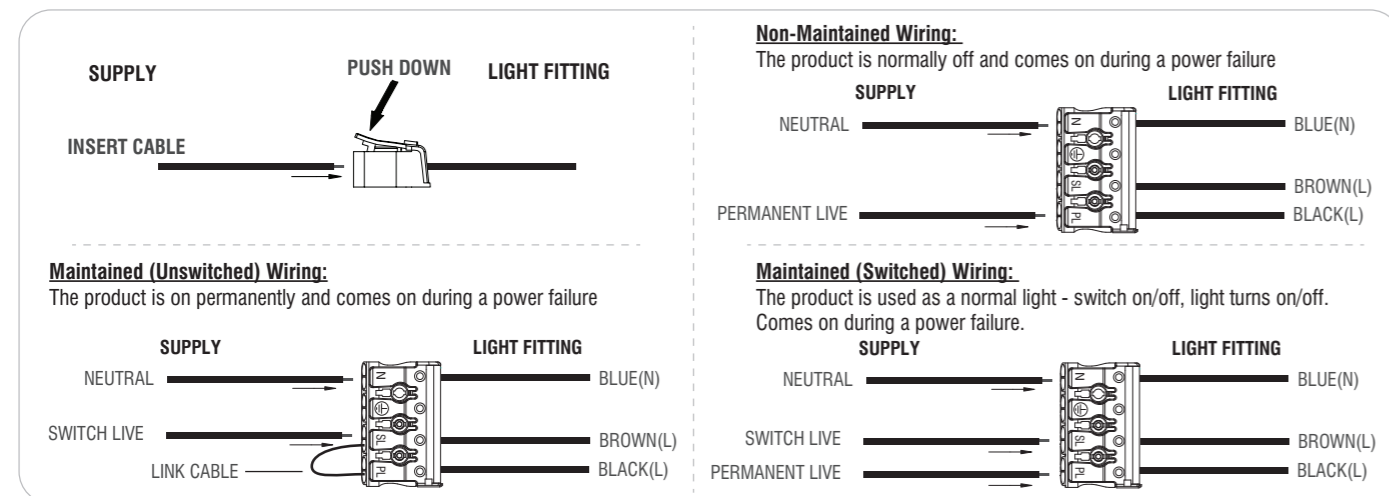

Check that...

- You have correctly identified the wires.
- No loose strands have been left out of the connection block
- The connections are tight.

Technical data

Supply Voltage: 220-240 V~, 50 Hz

Bulb Type: 95540----18/14/9W LED module (SMD) CCT, 3000/4000/6000K
103935---12/9/6W LED module (SMD) CCT, 3000/4000/6000K
103938---28/24/20W LED module (SMD) CCT, 3000/4000/6000K

This product contains a light source of energy efficiency class **D**.



UK CA Conformity with all relevant UKCA Directive requirements.

CE Conformity with all relevant EC Directive requirements.

The power supply is Double Insulated and does not require connection to an Earth circuit.

Waste electrical products should not be disposed of with household waste. Please recycle where facilities exist. Check with your Local Authority or local store for recycling advice.

Battery parameters:	
Lumens	120Lm in EM mode
Duration	3 hours (180 Minutes)
Operating Temperature	0°C - 50°C
Maximum Operating Humidity	90%
Change over time	Approximately 1s
Battery Specification	LifePO4 3.2V 1500mAh
Battery Charge Time	24 Hours
Battery warranty	2 years

- ⊗ This product is not suitable for dimming.
- IP65 This product is rated at IP65
- IK10 This product is rated at IK10 for 95540, 103935.
- IK08 This product is rated at IK08 for 103938.

Care and Safety

We recommend cleaning with a soft dry cloth. Do not use solvents or abrasive cleaners as these could damage the finish.

For your safety, always switch off the power supply before cleaning.

For further information, please visit <https://www.lighting-info.co.uk/95540>

V4 15/12/2022
UK Manufacturer: BH17 7BY
EU Manufacturer: Brilliant AG,
Brilliantstrasse 1, D-27442 Gnarrenburg

saxby
lighting

Instruction manual

HeroPro CCT Emergency

95540, 103935, 103938



www.saxbylighting.com

saxby
lighting

Thank you for purchasing this light fitting. Please read the instructions carefully before use to ensure safe and satisfactory operation of this product. Please retain these instructions for future reference.

Warning

This light fitting is double insulated and does not require connection to an earth circuit.

Please read these instructions carefully before commencing any work.

This unit must be fitted by a competent and qualified electrician.

Install in accordance with the IEE Wiring regulations and current Building Regulations.

Check the pack and make sure you have all the parts listed.

To prevent electrocution switch off at the mains supply before installing or maintaining this fitting. Ensure other persons cannot restore the electrical supply without your knowledge.

If you are in any doubt, please consult a qualified electrician.

This light fitting should be connected to a circuit with a 30mA RCD fitted.

If replacing an existing fitting, make a careful note of the connections.

Waste electrical products should not be disposed of with household waste. Please recycle where facilities exist. Check with your local authority or retailer for recycling advice.

Layout

Plan the desired layout of these fittings carefully, ensuring the cables will reach the distances between each light fitting.

Avoid locating any cables in positions that would cause a hazard. Position cables and junction boxes (not supplied) away from areas where they may be at risk from being cut, trapped or damaged.

The mains supply cable must have a minimum cross section area of 1.0mm².

Cables must be protected using suitable conduit or plastic trunking.

The products can be wall or ceiling mounted. If wall mounting ensure that the power supply is at the bottom.

Installation

Existing fittings must be completely removed before installation of a new product. Before removing the existing fitting, carefully note the position of each set of wires.

Note the switch is turned off before installation.

The ceiling surface must be flat and smooth to ensure a good fit.

Ensure that the screws and cable entry points are sealed to maintain the IP rating of the product.

- Twist and remove the lamp cover from the product, keep safe for refitting later.
- Turn the clip to loose the LED tray in the rear casing.
- Using the rear casing as a template mark the position to drill out the fixing holes. Take care to avoid damaging any concealed wiring and pipes.
- Fix the rear casing into the position using the installation plugs and screws.
- Pull the cable through the cable entry hole and seal to maintain the IP rating and wire as detailed Wiring Diagram.
- Unscrew the battery box cover and then connect the battery DC connector together before commissioning.
- Refit the LED tray back into the rear casing and lock the clip.
- Twist the lamp cover back onto the product and lock in place.
- Replace fuse or circuit breaker and switch on. Your light is now ready for use.

The wattage is changeable between the different wattage using the wattage switch on the driver before installation.

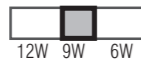
 For the 103935 is the 12W/9W/6W selectable

 For the 95540 is the 18W/14W/9W selectable

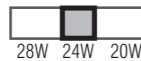
 For the 103938 is the 28W/24W/20W selectable

The colour is changeable between 3000/4000/6000K using the CCT switch on the driver before installation.

 6000K 4000K 3000K

Choose your preferred wattage and colour before installing by wattage switch or CCT switch on the driver.

Note: Before you change the wattage or colour, please turn off the power switch for safety.



* Product images may vary.

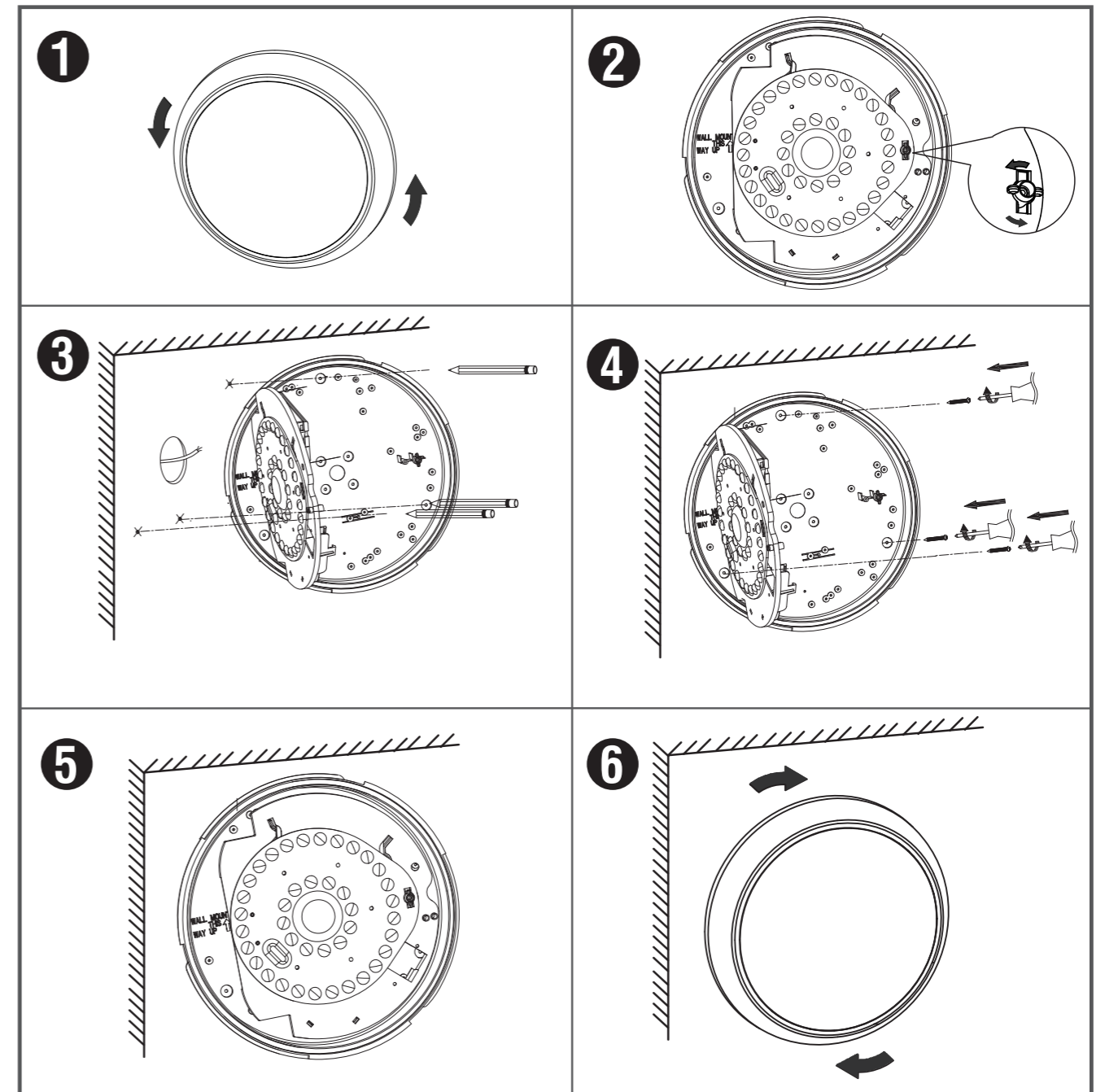

Bezels for 95540 only

The following individual casings are available for purchase separately.

- | | | |
|----------------------|----------------------|--------------------------------|
| 95545 : Chrome plain | 95548 : Black plain | 95551 : Anthracite grey plain |
| 95546 : White eyelid | 95549 : Black eyelid | 95552 : Anthracite grey eyelid |
| 95547 : White grill | 95550 : Black grill | 95553 : Anthracite grey grill |