

# Additional instruction manual

To prevent electrocution **switch off** at the mains supply before installing or maintaining this fitting.  
Ensure other persons **cannot** restore the electrical supply without your knowledge.

## Rular 78554, 78555, 78556, 78557, 78558 with Corridor

Accessories:



94056 Rular Sensor



95191 5W Driver

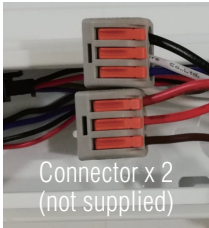

Connector x 2  
(not supplied)

- 01. Locate the 94056 sensor position.
- 02. Take off the brown / blue wires between the LED driver and the terminal.
- 03. Take appropriate length of the brown and blue wires connect sensor's **L / N** to terminal's **L / N**.
- 04. Take appropriate length of brown and blue wires, connect sensor's **L' / N'** to **L / N** of LED driver input end.
- 05. Install the 94056 sensor controller and replace the end cap (sensor detector in the end cap).

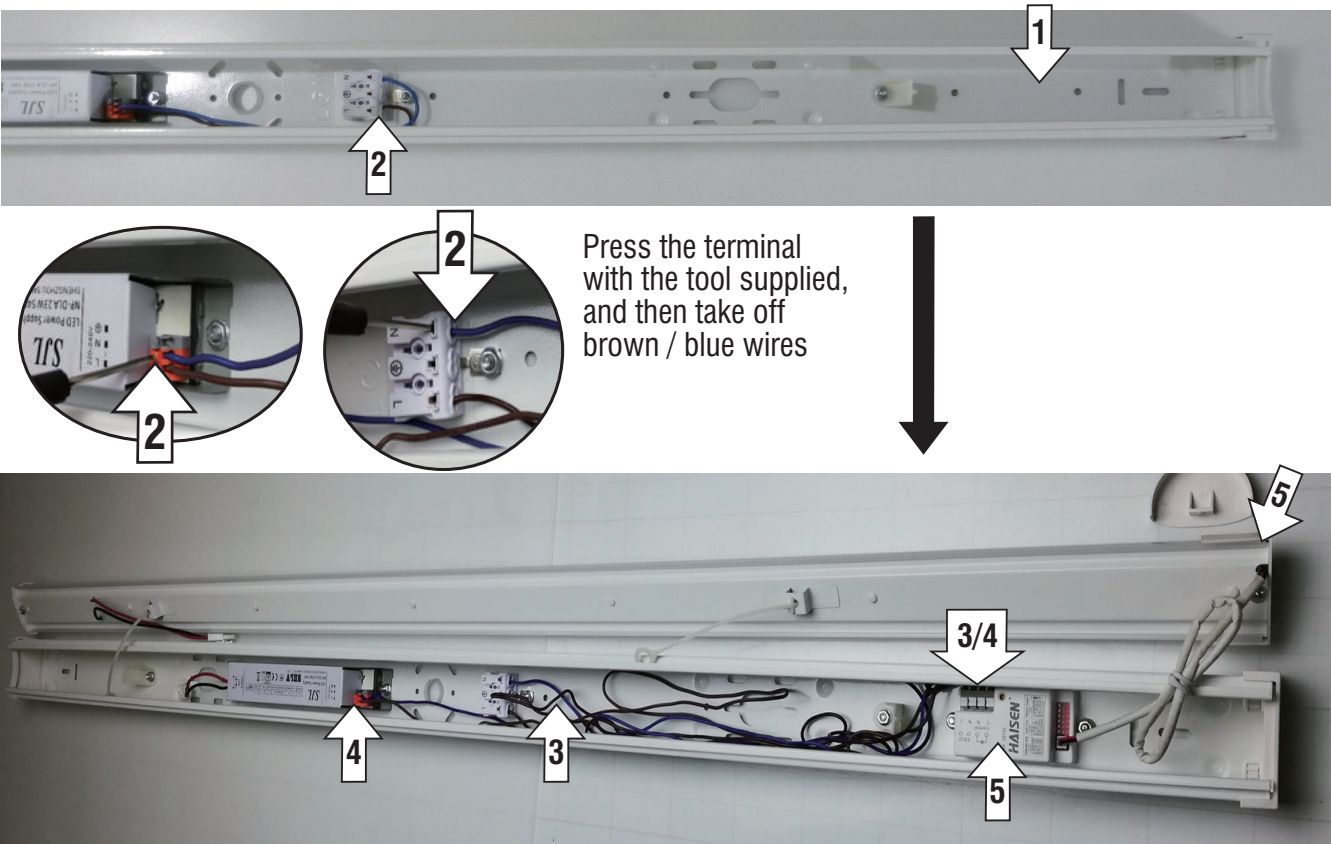

- 06. Install the 95191 5W driver.
- 07. Joint male and female connector. Take off the **red / black** wire from output end of the LED driver, and connect to two connectors separately.
- 08. Take appropriate length of two brown wires and two blue wires, connect LED driver and the 95191 5W driver output ends **+ / -** to two connectors separately.
- 09. Take appropriate length of the brown and blue wires, connect the 95191 5W driver input end to terminal's **L / N**.

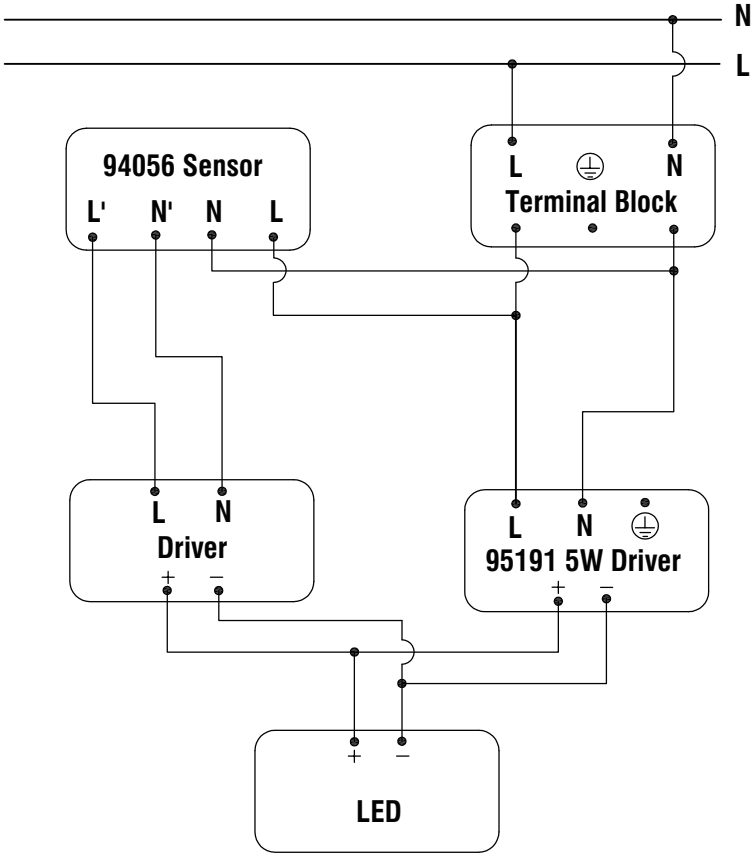
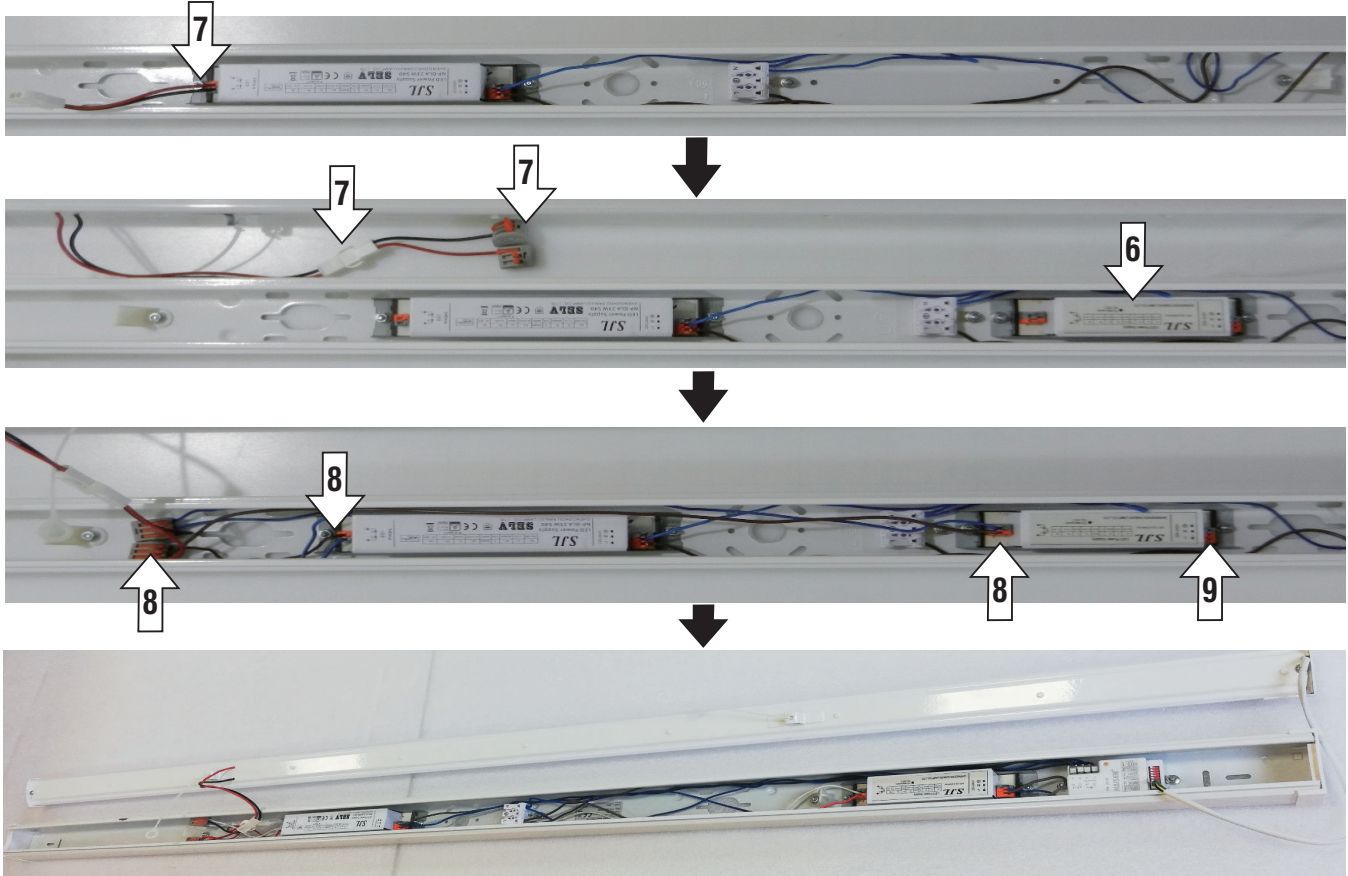



# Rular 78559 with Corridor

Accessories:

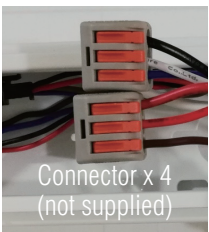

- 01. Locate the 94056 sensor position.
- 02. 1) Remove all wires from terminal **L / N**;  
2) Locate the blue / brown wires connected with No.1 LED driver, then connect the wires to two connectors separately (don't remove the wires from No.1 LED driver);  
3) Locate the blue / brown wires connected with No.2 LED driver, and remove the wires from driver.
- 03. Take appropriate length of brown and blue wires, connect sensor to terminal's **L / N** separately.
- 04. Take appropriate length of the brown and blue wires, connect sensor's **L' / N'** to two connectors separately.
- 05. Take appropriate length of the brown and blue wires, connect **NO.2** LED driver's **L / N** to two connectors separately.
- 06. Install the 94056 sensor controller and replace the end cap (sensor detector in the end cap).

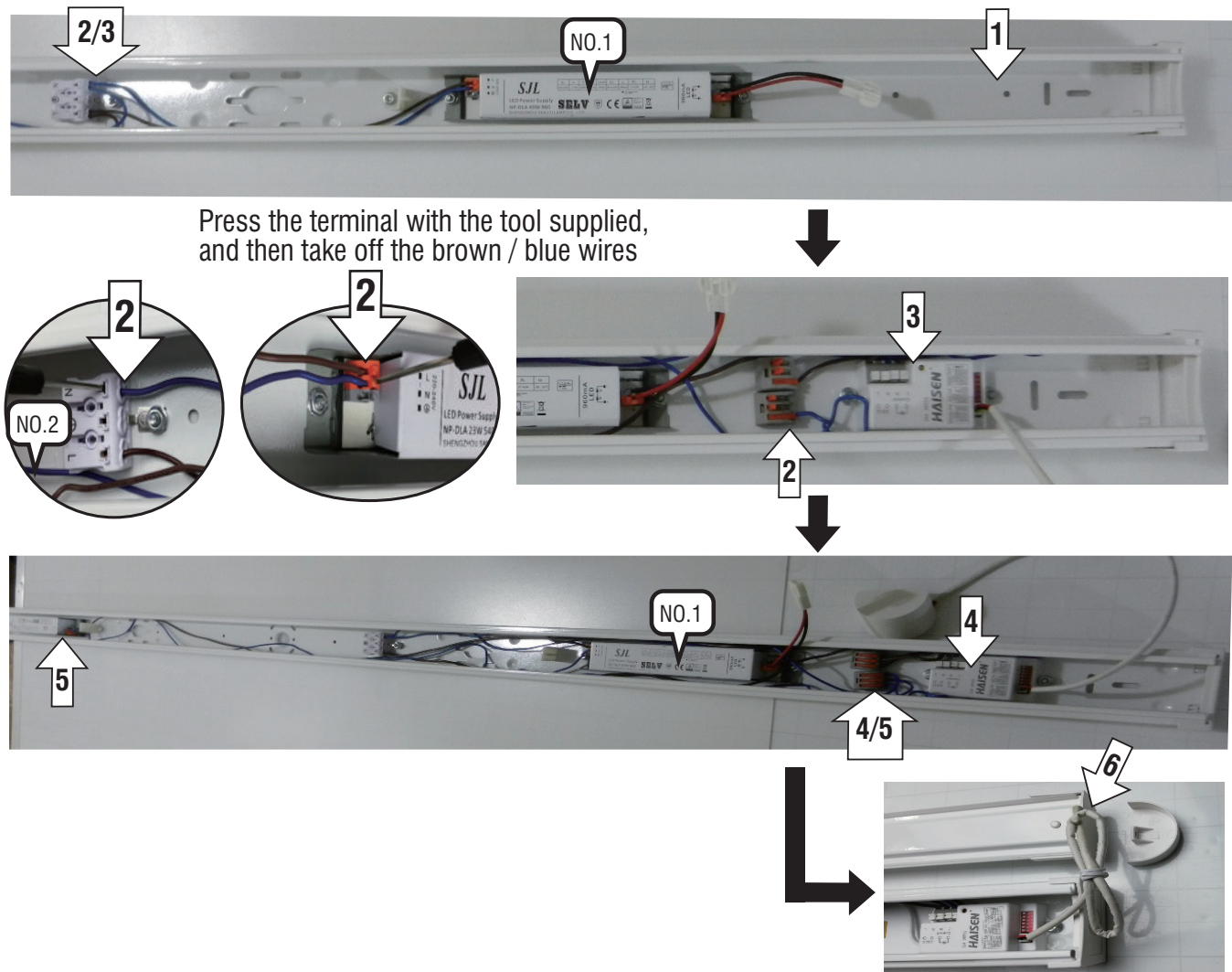

- 07. Take another two connectors. Joint male and female connector. Take off the **red / black** wire from output end of the LED driver, and connect to two connectors separately.
- 08. Install the 95191 5W driver.
- 09. Take appropriate length of the brown and blue wires, connect the 95191 5W driver input end to terminal's **L / N**.
- 10. Take two brown wires and two blue wires with suitable length, connect **NO.2** and the 95191 5W driver's output ends **+ / -** to two connectors separately.

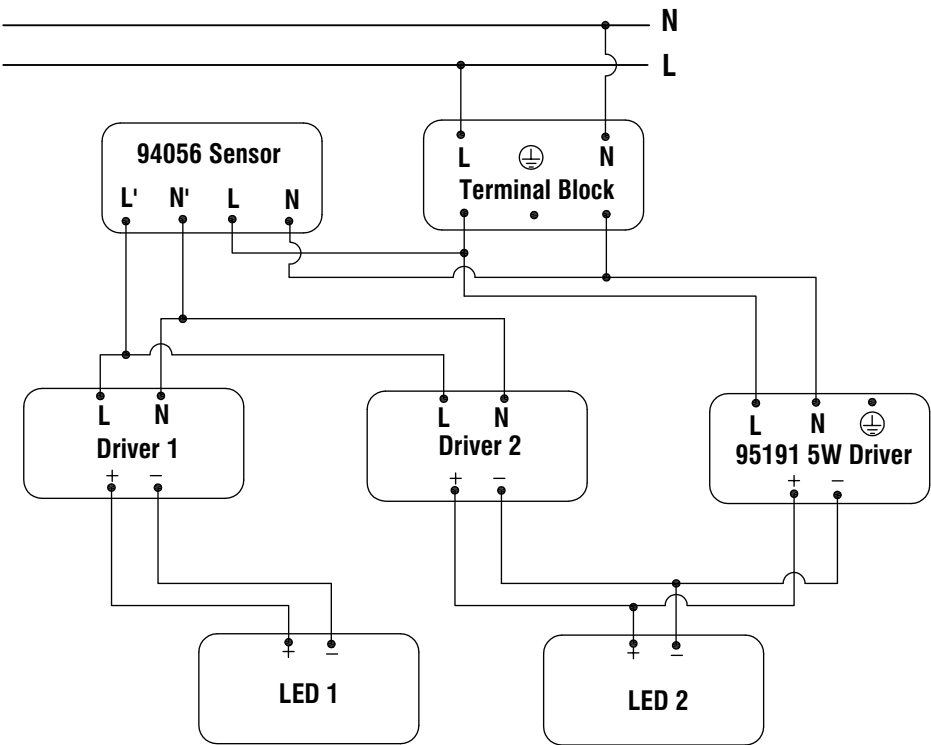
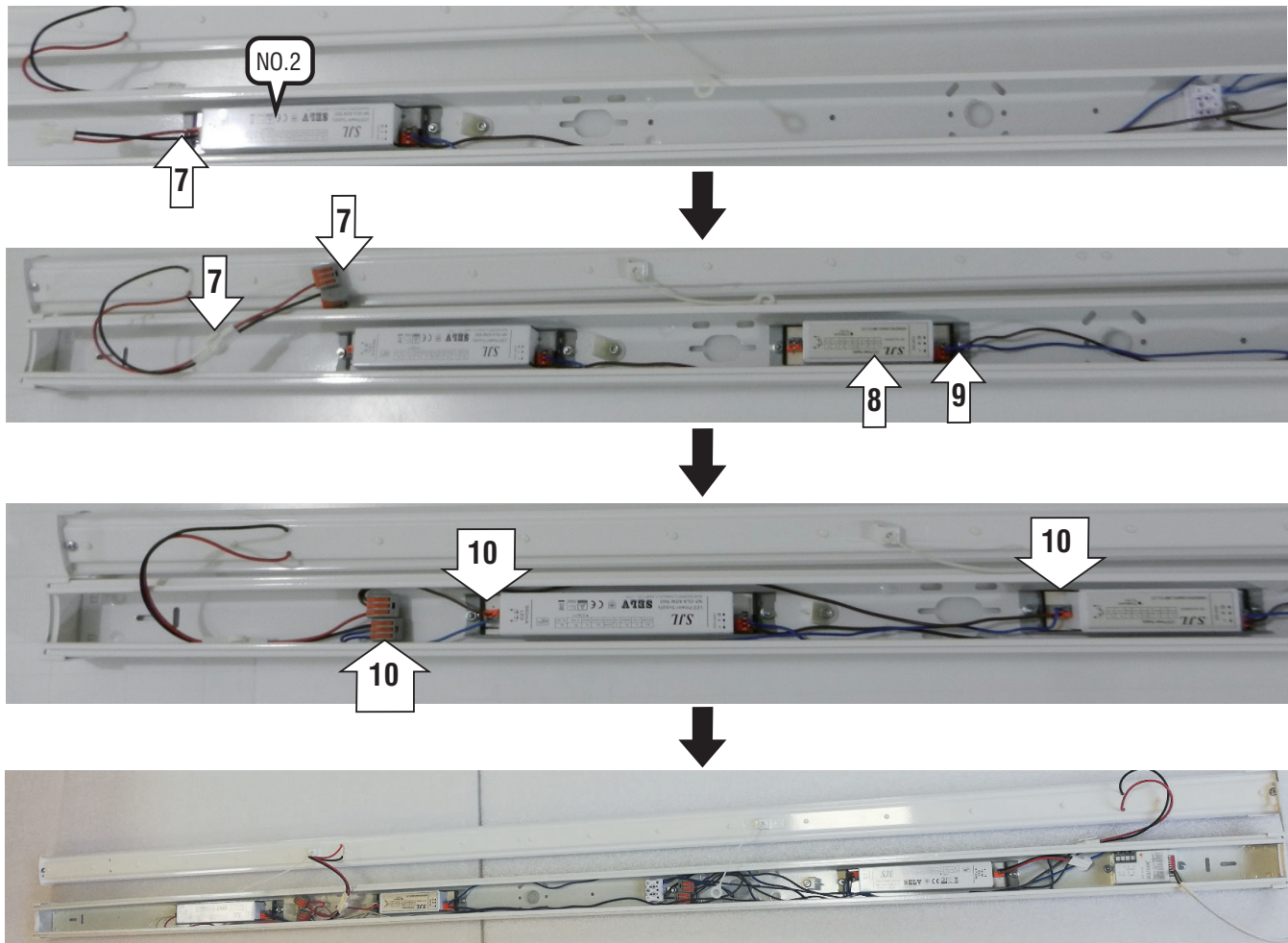



# Additional instruction manual

To prevent electrocution **switch off** at the mains supply before installing or maintaining this fitting.  
Ensure other persons **cannot** restore the electrical supply without your knowledge.

## Rular EM 78561, 78562, 78564 with Corridor

Accessories:

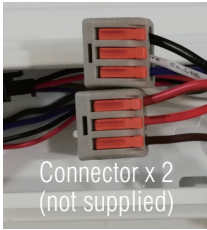

- 01. Locate the 94056 sensor position.
- 02. Take off the brown / blue wires between the LED driver and the terminal **2(Ls) / N**.
- 03. Take appropriate length of brown and blue wires, connect sensor's **L / N** to terminal's **2(Ls) / N**.
- 04. Take appropriate length of the brown and blue wires, connect sensor's **L' / N'** to LED driver input end's **L / N**.
- 05. Install the 94056 sensor controller and replace the end cap (sensor detector in the end cap).

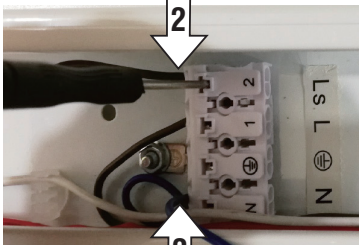

Press the terminal with the tool supplied, and then take off the brown / blue wires

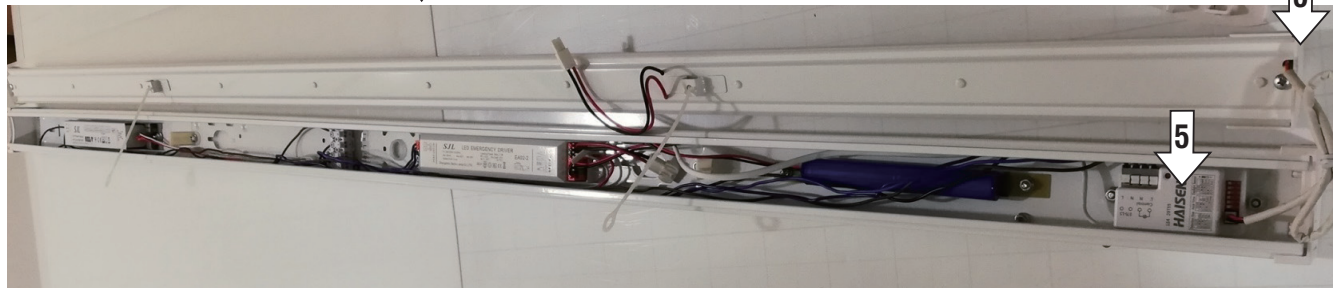
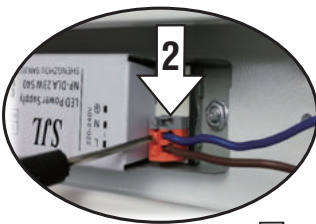
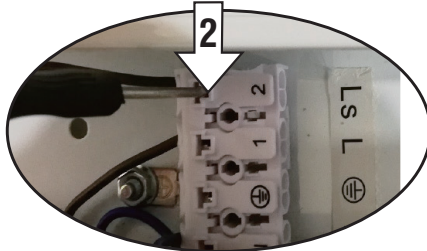

- 06. Install the 95191 5W driver.
- 07. Take appropriate length of brown and blue wires then connect terminal's **2(Ls) / N** to 95191 5W driver's **L / N** separately.
- 08. Joint male and female connector. Take off the **red / black** wire from EM driver.
- 09. Connect **red / black** wire (Step 08 ) to two connectors separately.
- 10. Take appropriate length of the red and white wires ,connect 95191 5W driver's output **+** & **-** and emergency driver's LED **+** / **-** to two connectors separately.

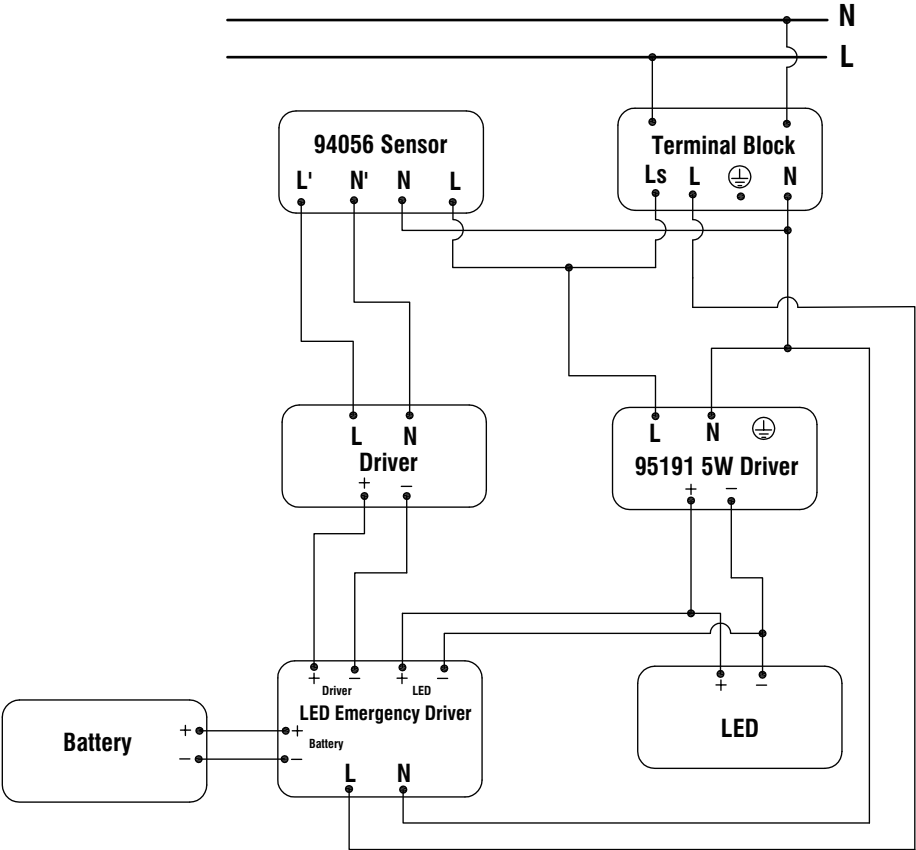
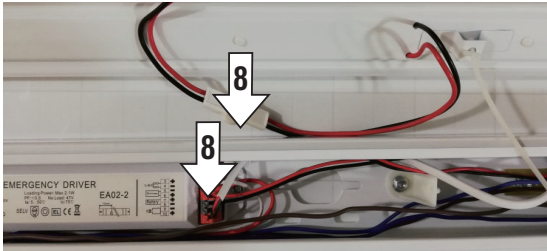
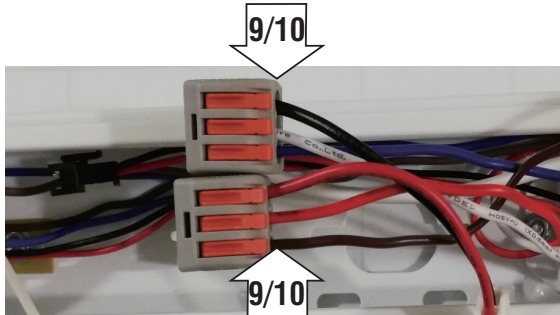
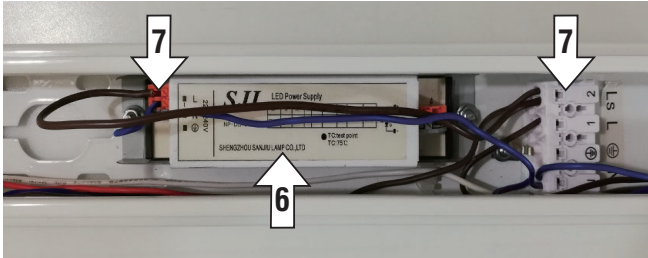



# Rular EM 78565 with Corridor

Accessories:



94056 Rular Sensor



95191 5W Driver

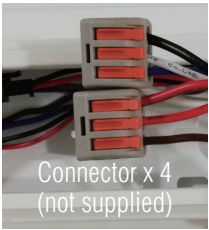

Connector x 4  
(not supplied)

- 01. Locate the 94056 sensor position.
- 02. 1) Locate the brown / blue wires between No. 1 driver and terminal's **2(Ls) / N**, remove them from terminal, and then connect the wires to two connectors separately;  
2) Locate the brown / blue wires between No. 2 driver and terminal's **2(Ls) / N**, remove them from terminal, and then connect the wires to two connectors separately.
- 03. Take appropriate length of the brown and blue wires, connect sensor's **L / N** to terminal's **2(Ls) / N** separately.
- 04. Take appropriate length of the brown and blue wires, connect sensor's **L' / N'** to two connectors separately.
- 05. Install the 94056 sensor controller and replace the end cap (sensor detector in the end cap).

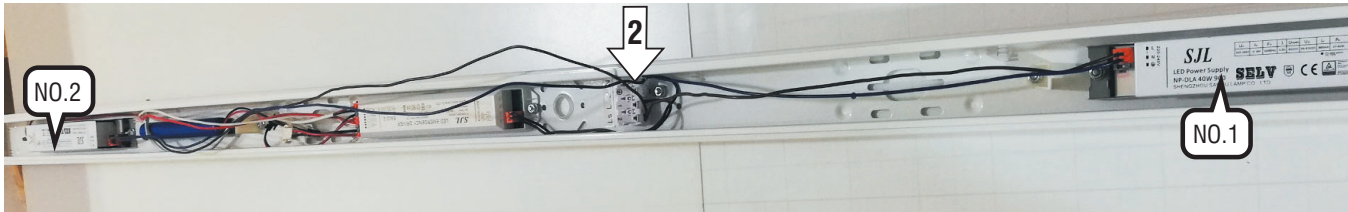

Press the terminal with the tool supplied, and then take off the wires

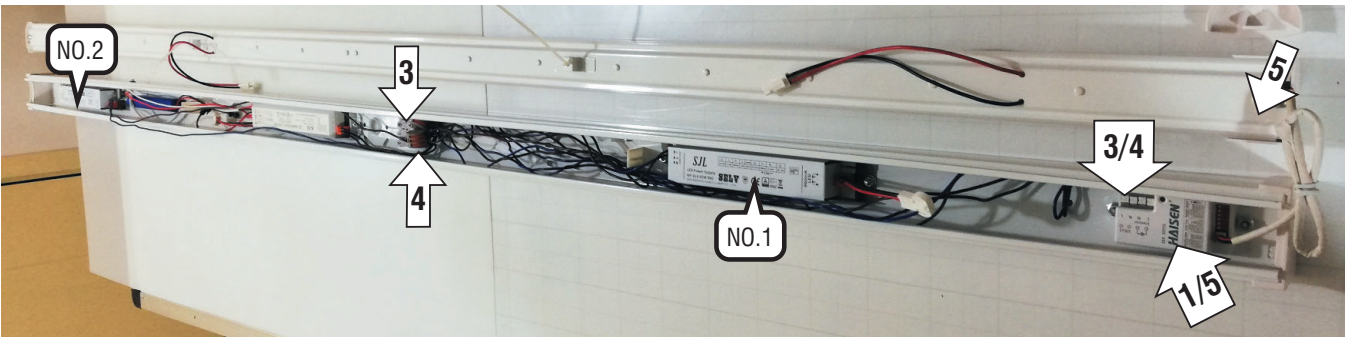
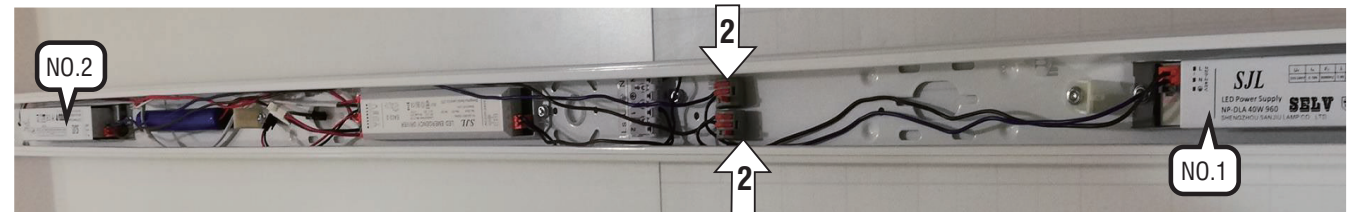
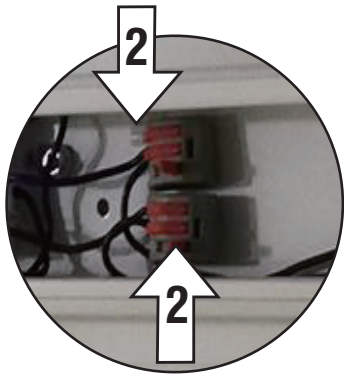
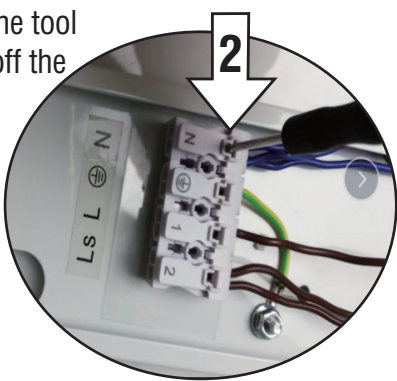

- 06. Install the 95191 5W driver.
- 07. Take appropriate length of brown and blue wires then connect terminal's **2(Ls) / N** to 95191 5W driver's **L / N** separately.
- 08. Take appropriate length of the red and white wires, connect 95191 5W LED driver's **+ / -** to two connectors separately.
- 09. Joint male and female connector. Take off the **red / black** wires from out put end **+ / -** of No. 1 LED driver, and connect to two connectors separately.
- 10. Take appropriate length of the **red** and **white** wires, connect No. 1 LED driver's **+ / -** to two connectors separately.

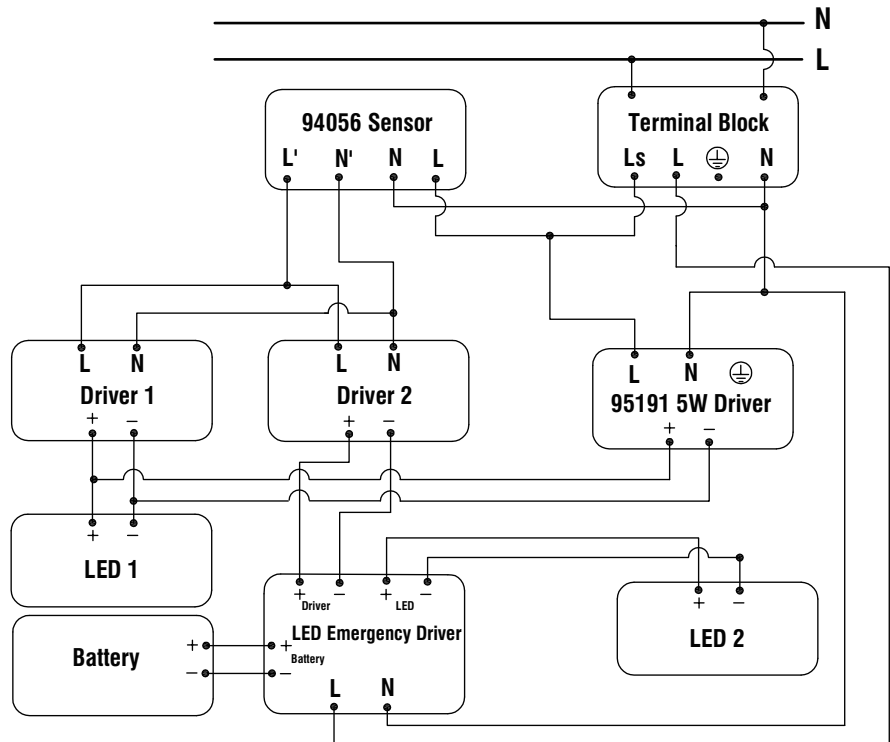
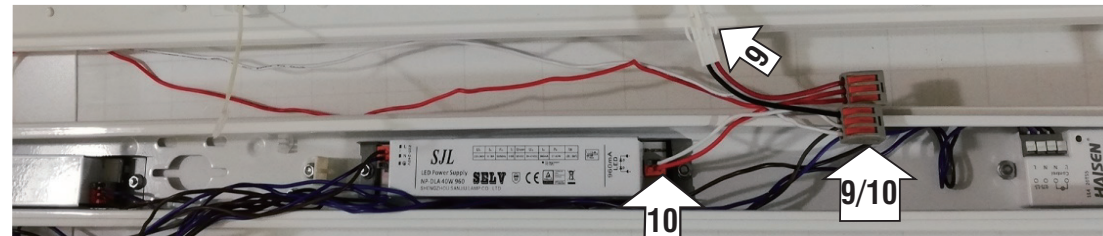
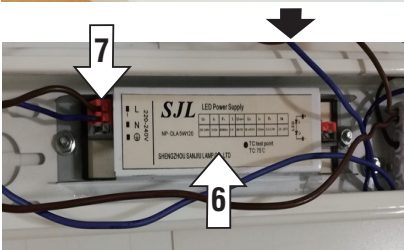
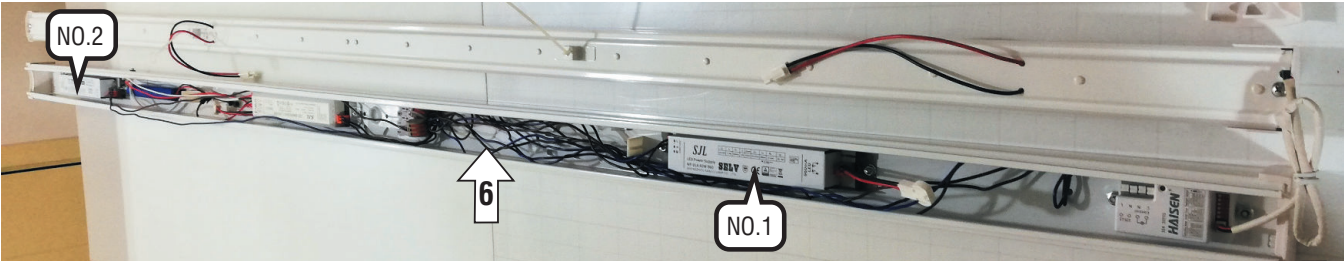



# Mordax 72700, 72701, 72702, 72703, 72704 with Corridor

Accessories:



- 01. Locate the 94057 sensor position.
- 02. Cut off the brown wire in appropriate length, connect the terminal's **L** to sensor's **L**, and connect the driver's **L** to sensor's **L'**.
- 03. Take appropriate length of the blue wire, connect sensor's **N** to terminal's **N**.
- 04. Install the 94057 sensor controller.

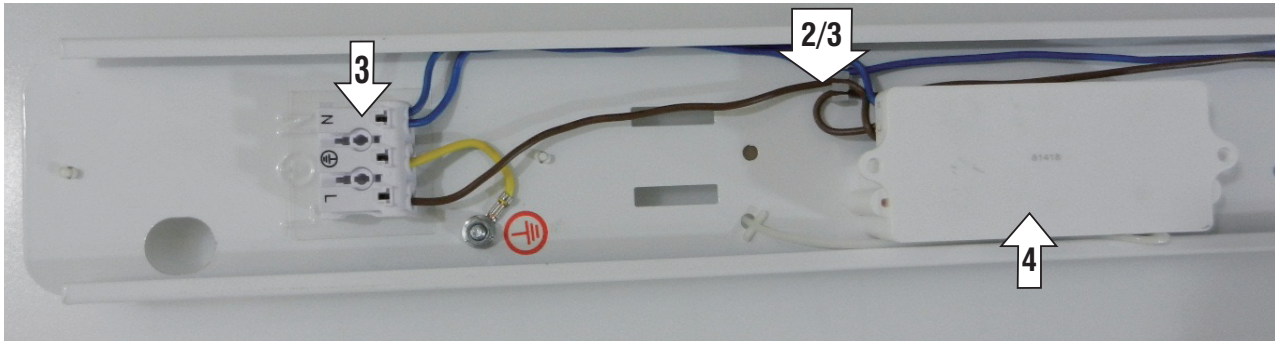
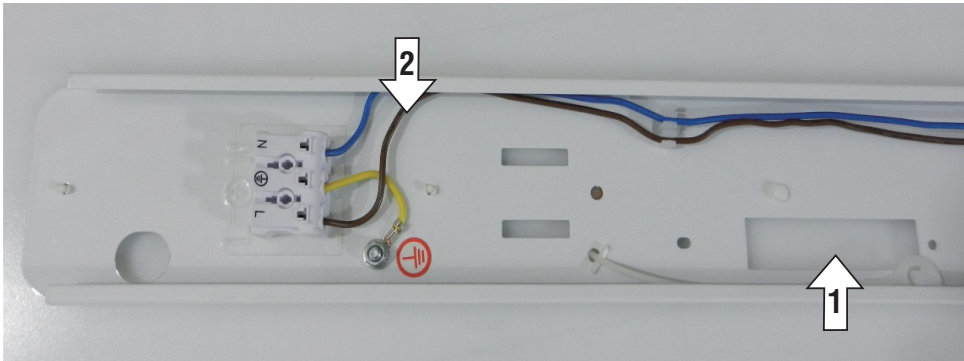

- 05. Install the 95191 5W driver.
- 06. Disconnect the wiring of LED driver output end, and connect to two connectors separately.
- 07. Take two brown wires and two white wires with suitable length, connect LED driver and the 95191 5W driver's **+** / **-** to two connectors separately.
- 08. Take appropriate length of the brown and blue wires, connect the 95191 5W driver and terminal's **L** and **N** separately.

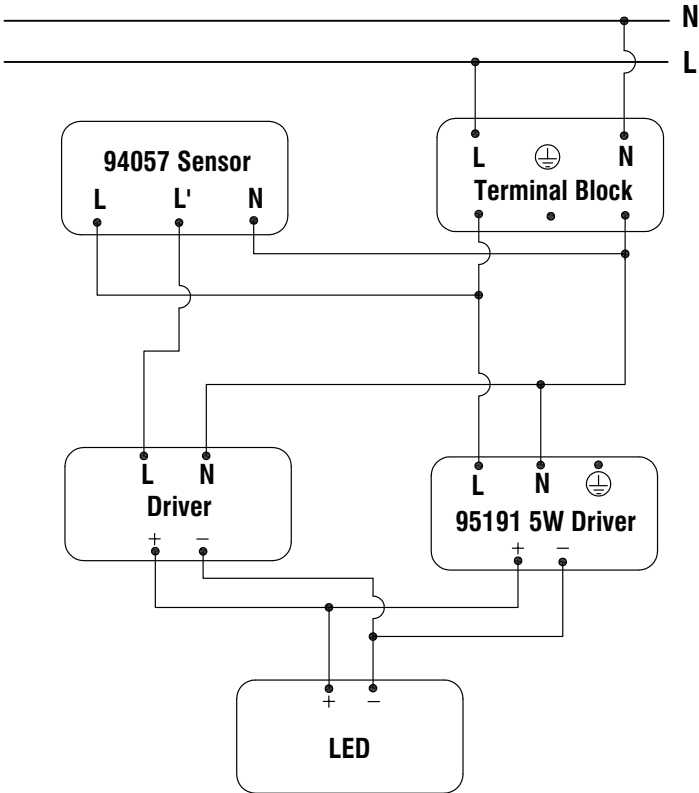
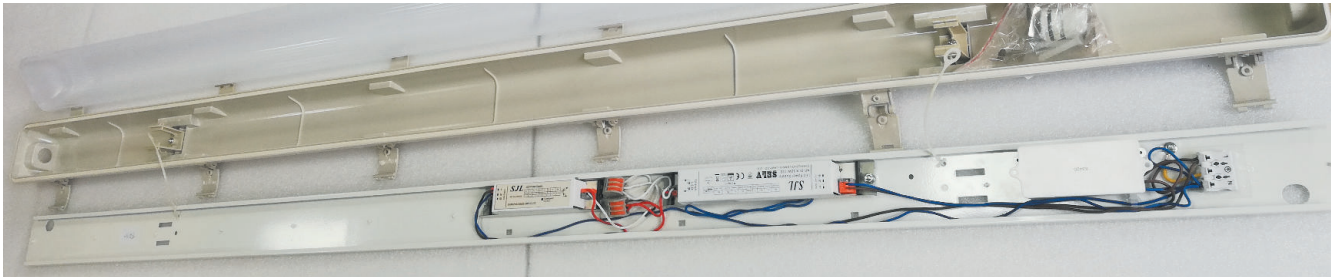
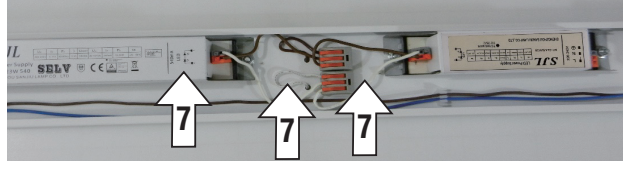
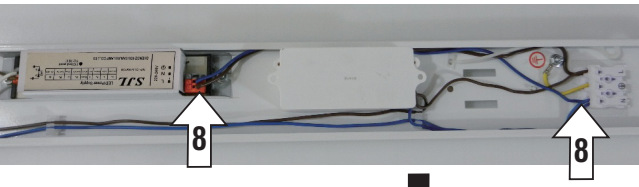
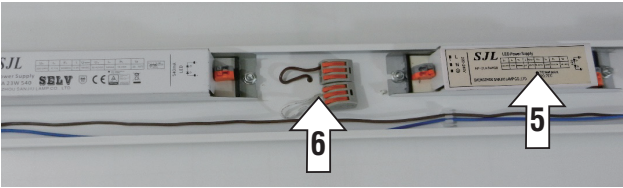
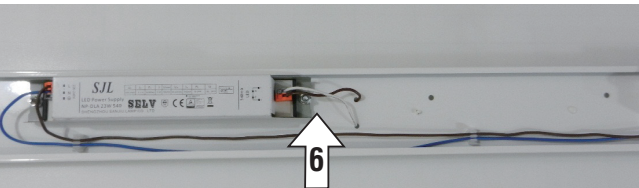



# Mordax 72705 with Corridor

Accessories:

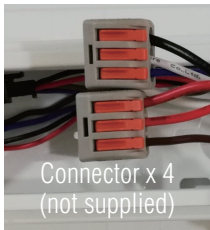

- 01. Locate the 94057 sensor position.
- 02. 1) Remove all wires from terminal **L / N**;  
2) Locate the blue / brown wires connected with No. 1 driver, then connect the wires to two connectors separately (don't remove the wires from No.1 LED driver);  
3) Locate the blue / brown wires connected with No. 2 driver, and remove the wires from driver.
- 03. Disconnect the brown wire between terminal and NO.2 LED drive (remove the wire of terminal end) then connect to connector A.
- 04. Take appropriate length of the brown wire, connect sensor's **L'** to connector A.
- 05. Take appropriate length of blue wire, connect sensor's **N** to terminal's **N**.
- 06. Install the 94057 sensor controller.

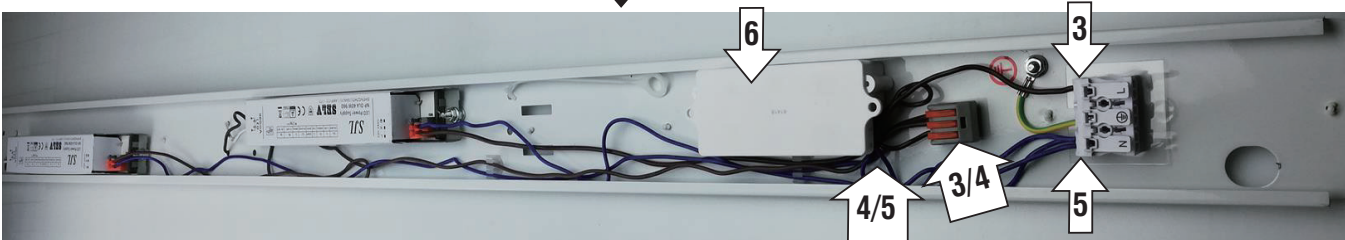
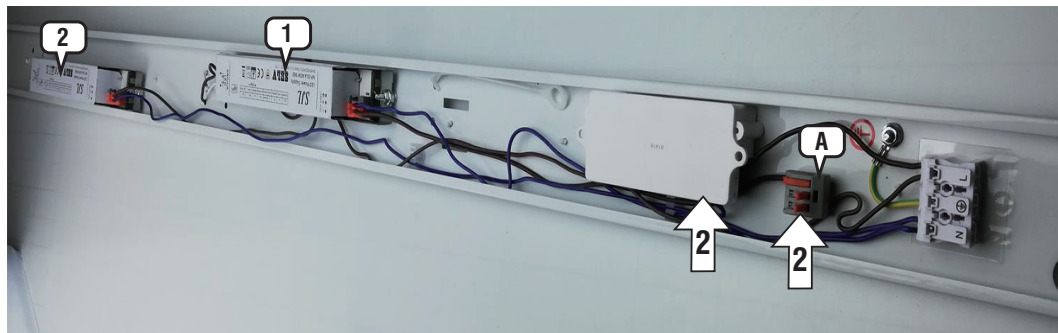
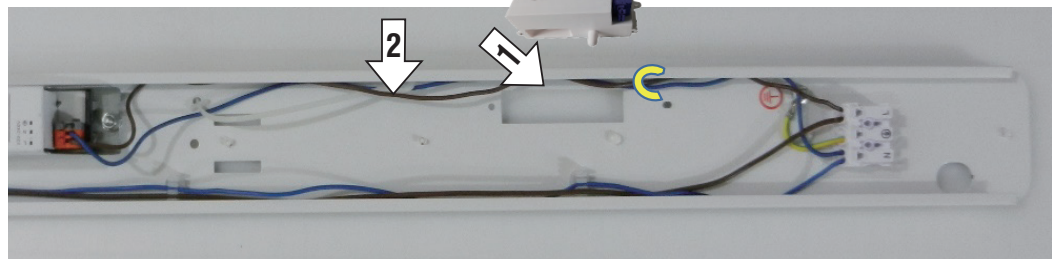

Press the terminal with the tool supplied, and then take off the brown wire

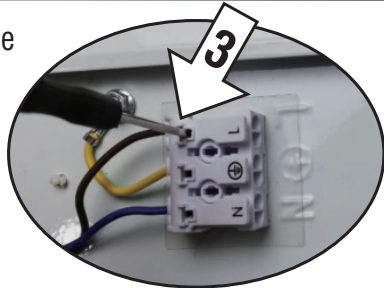

- 07. Disconnect the wired from NO.1 LED driver output end than respectively connect to two connectors C & D.
- 08. Install the 95191 5W driver.
- 09. Take two brown wires and two blue wires of suitable length respectively connect NO.1 and the 95191 5W driver's output end's **+** / **-** to two connectors C & D.
- 10. Disconnect (terminal end) NO.1 and 2 LED driver to terminal's blue wire than connect in one connector B.
- 11. Take the blue wire of suitable length connect terminal's **N** to connector B.
- 12. Take appropriate length of the blue and brown wire respectively connect the 95191 5W driver input end's **L / N** to terminal.

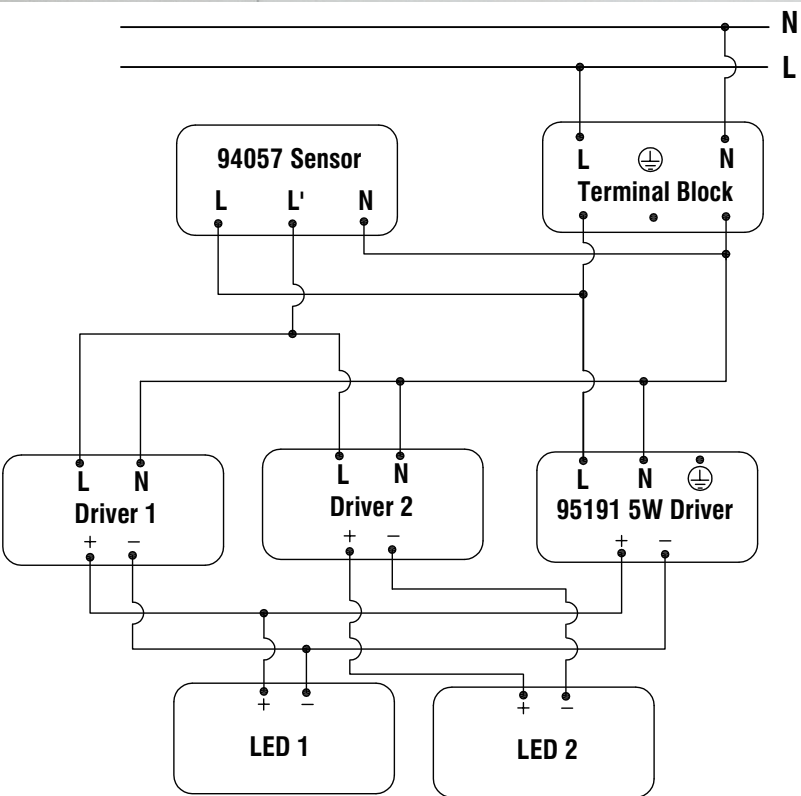
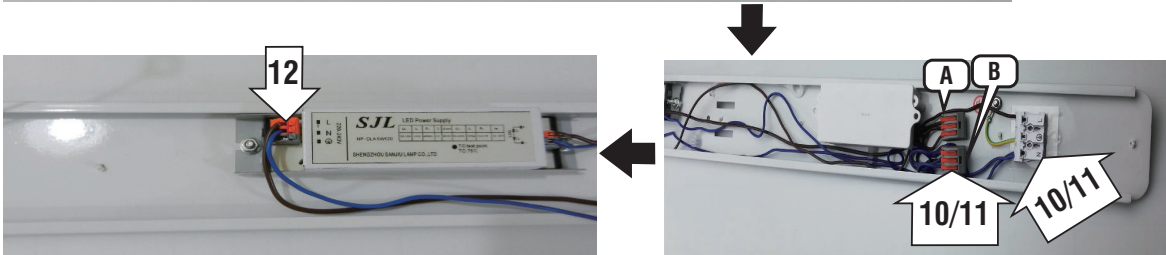



# Mordax EM 72707, 72708, 72710 with Corridor

Accessories:



- 01. Locate the 94057 sensor position.
- 02. Cut off the brown wire between terminal's **2(Ls)** and LED driver in the appropriate length. connect the terminal's **2(Ls)** to sensor's **L**, and connect the driver's **L** to sensor's **L'**.
- 03. Take appropriate length of the blue wire, connect sensor's **N** to terminal's **N**.
- 04. Install the 94057 sensor controller.

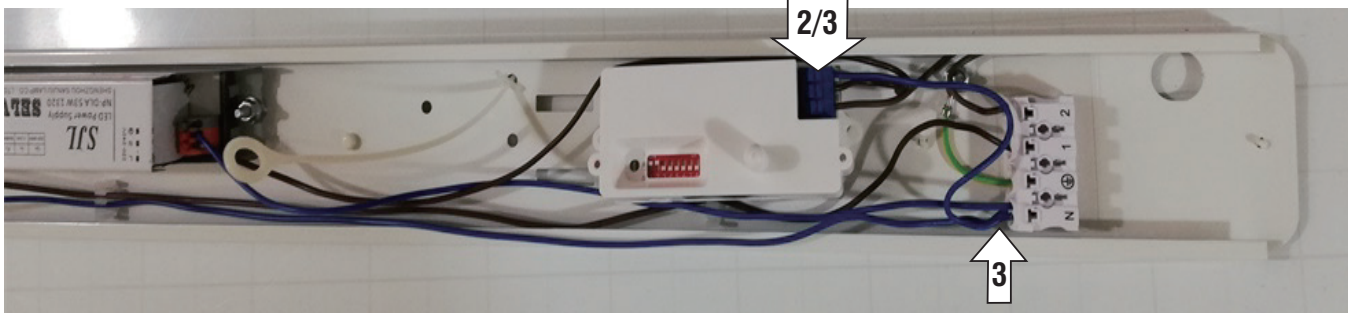
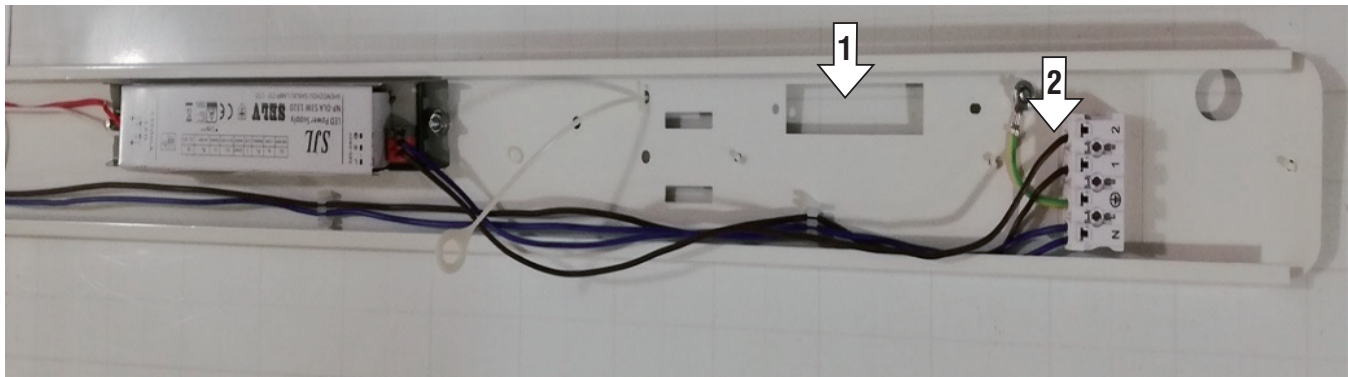

- 05. Disconnect the blue wire of LED driver input end then connect to the connector.
- 06. Take appropriate length of the blue wire, connect LED driver's **N** to the connector.
- 07. Take appropriate length of the blue wire, connect the 95191 5W driver's **N** to connector.
- 08. Take appropriate length of the brown wire, connect the 95191 5W driver's **L** to terminal's **2(Ls)** and installation the 95191 5W driver.
- 09. Disconnect 'LED' wires of the emergency driver and connect to the two connectors separately.
- 10. Take appropriate length of the red and white wires, connects emergency driver LED end to two connectors separately.
- 11. Take appropriate length of the red and white wires, connect the 95191 5W driver output end **+** / **-** to two connectors

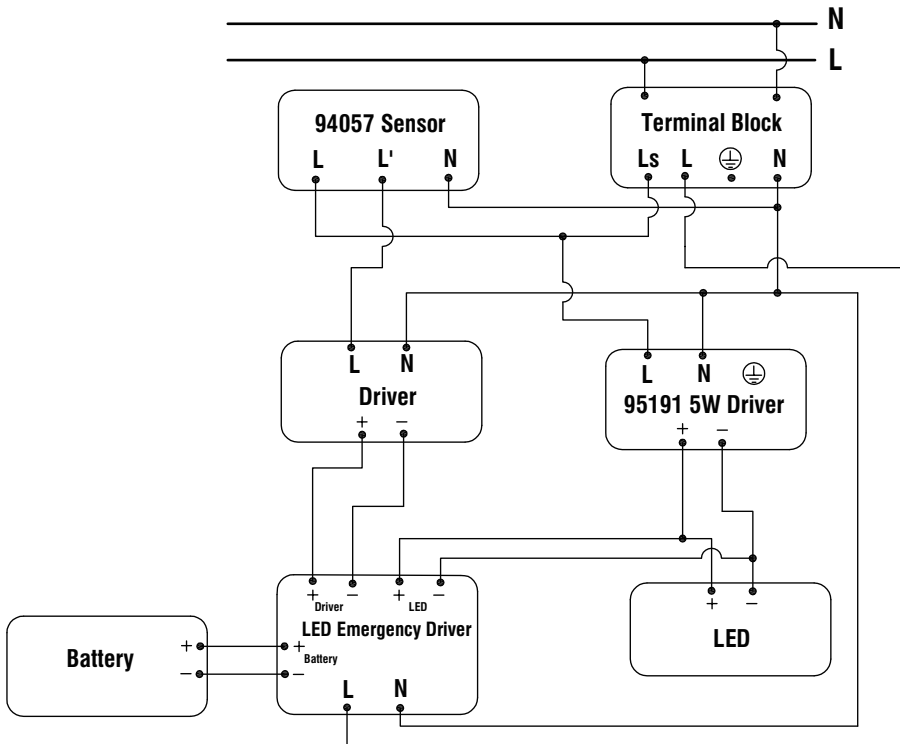
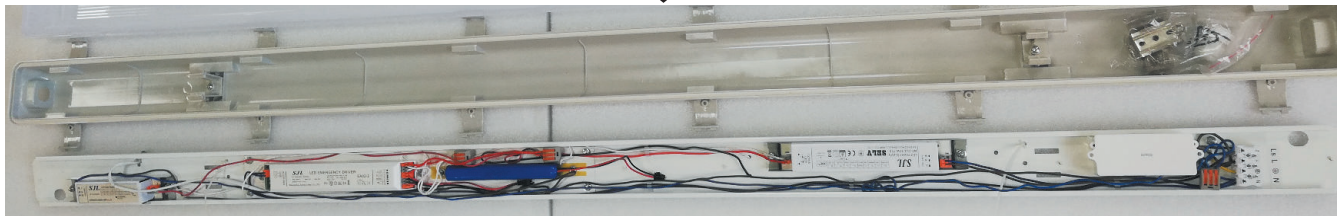
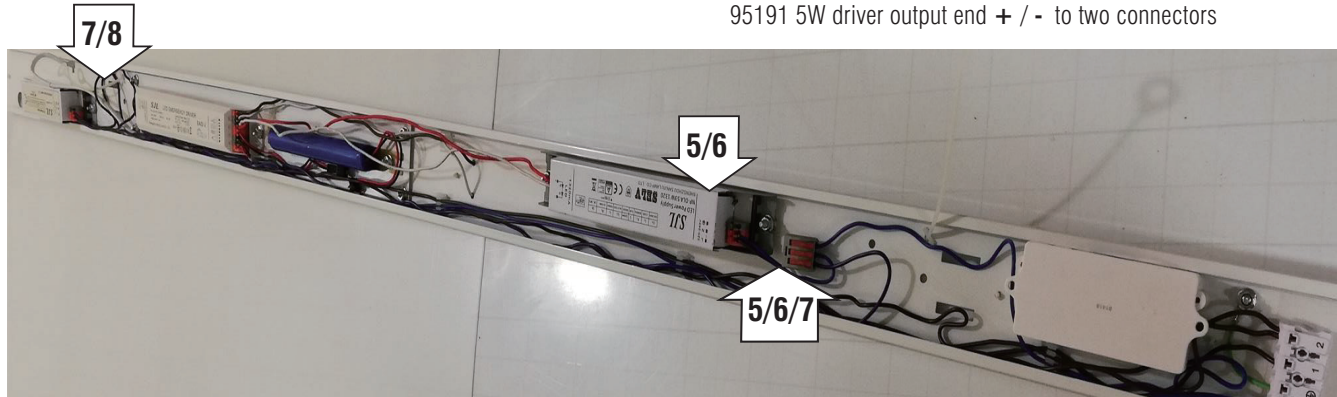



# Mordax EM 72711 with Corridor

Accessories:

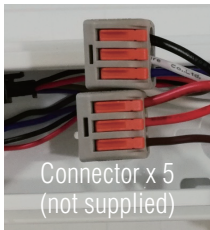

- 01. Locate the 94057 sensor position.
- 02. Cut off two brown wires between terminal's **2(Ls)** and NO.1 & NO. 2 LED drivers in the appropriate length. Connect terminal's **2(Ls)** to sensor's **L** with one of the brown wire, and take off the other one, use it to connect sensor's **L'** to one connector (A).
- 03. Connect two brown wires of NO.1 and NO.2 LED driver to the connector (A).
- 04: 1) Locate the blue wire between No. 1 driver and terminal **N**, remove it from terminal, and then insert it into connector (B); 2) Locate the blue wire between No. 2 driver and terminal **N**, remove it from terminal end, and then insert it into connector (B).
- 05. Take blue wire in the appropriate length, connect terminal's **N** to the connector (B).
- 06. Take blue wire in the appropriate length, connect terminal's **N** to sensor's **N**.
- 07. Install the 94057 sensor controller.

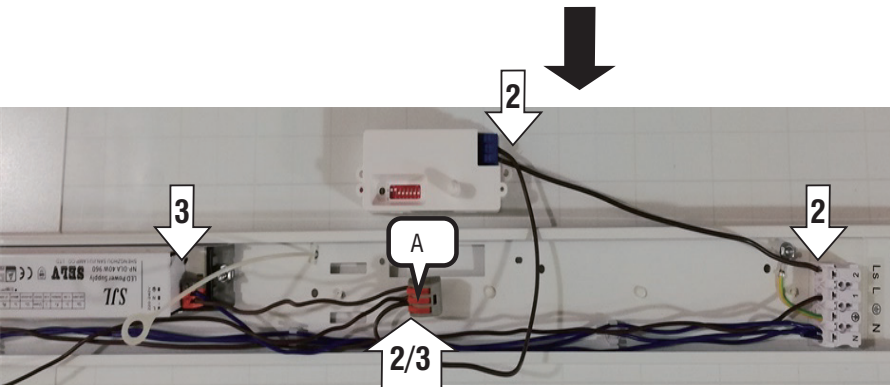
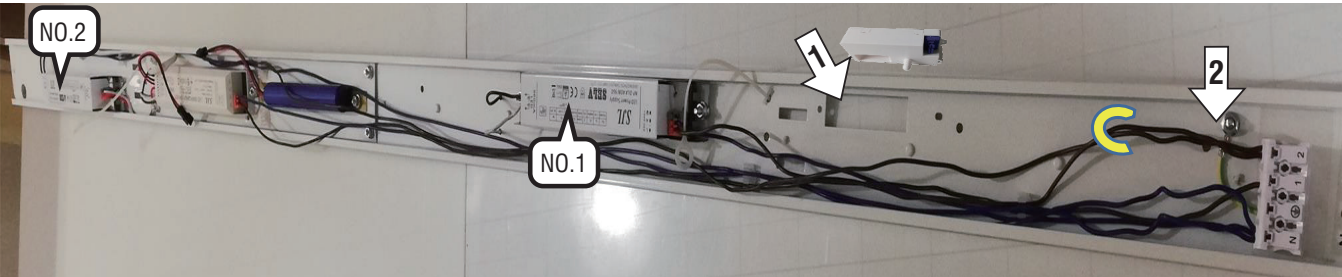

Press the terminal with the tool supplied, and then take off the wires

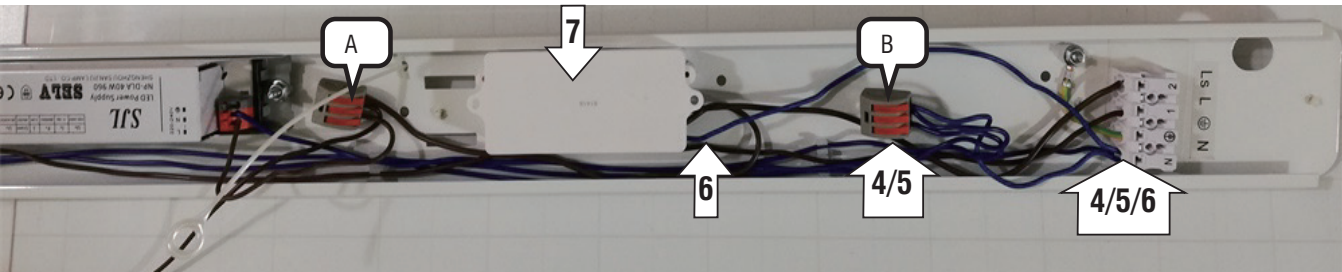
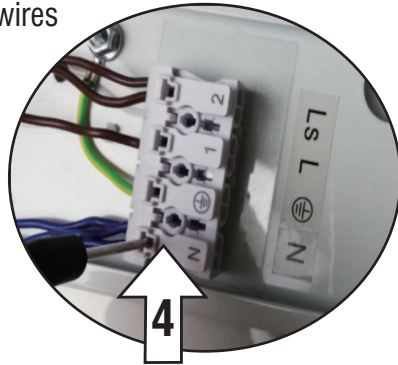

- 08. Install the 95191 5W driver.
- 09. Locate the blue wire between sensor's **N** and terminal's **N**, remove it from sensor, and then insert it into connector (C).
- 10. Take two blue wires with suitable length, connect sensor's **N** and 95191 5W driver's **N** to connector (C) separately.
- 11. Take appropriate length of the brown wire, connect the 95191 5W driver's **L** to terminal's **2(Ls)**.
- 12. Take appropriate length of the red and white wires, connect the 91915W driver's **+** / **-** to two connectors (D, E) separately.
- 13. Disconnect the wiring of the NO.1 LED driver output end and connect to two connectors (D, E).
- 14. Take appropriate length of the red and white wires, connect NO.1 LED driver's **+** / **-** to two connectors (D, E).

