

LOOX MECHANICAL SWITCHES

Part of the Loox plug and play system the push button and rocker switches are suitable for recess mounting where as the door contact switch can be surface mounted with the housing shown below.

Loox push button switch



- > For recess mounting in Ø 12 x 13.5 mm hole
- > With 2.0 m lead with connector, fits any Loox driver
- > Plastic
- > Order qty: 1 pc

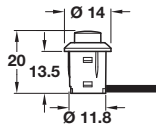

Finish	Cat. No.
Black	833.89.108
Grey coloured	833.89.107

Loox rocker switch



- > For recess mounting in Ø 12 x 13.8 mm hole
- > With 2.0 m lead with connector, fits any Loox driver
- > Plastic
- > Order qty: 1 pc

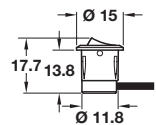

Finish	Cat. No.
Black	833.89.106

Loox door contact switch



- > Drill hole: Ø 12 mm
- > With 2.0 m lead with connector; fits any Loox driver
- > Plastic
- > Order qty: 1 pc

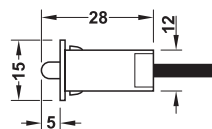

Finish	Cat. No.
Black	833.89.059

Loox housing for switch, surface mounting



- > Only for use with Ø 13 mm Loox door contact switch shown above
- > Plastic
- > Order qty: 1 pc

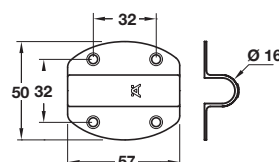

Finish	Cat. No.
Black	833.89.048