

## Wiring

If not using the supplied plug then the product must be wired to a IP67 rated terminal block.

Having correctly identified the wiring from your existing light fitting, connect to the approved outdoor rated external terminal block in the following way:

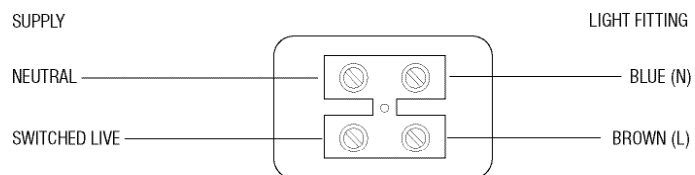

## RF Control - 59136, 59137, 59138

- Push the plug into the mains socket and switch on.
- Slide the battery cover off the RF controller and fit the battery observing the correct polarity markings.
- Press the On / Off button on the RF controller. The red LED should light at the top, and the signal LED should light on the power supply.
- Push the RGB button to switch between the different colours. There are seven individual colours and then two variable modes.
- The fixed colour sequence is yellow, white, red, green, blue, purple and light blue.
- There are two variable modes. One switches between all seven colours and the other fades between them.
- The sequence will repeat from the start.

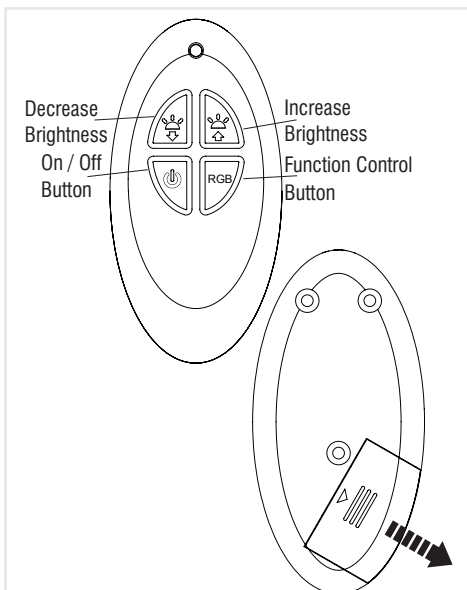

## Care and Cleaning

We recommend cleaning with a soft dry cloth. Do not use solvents or abrasive cleaners as these could damage the finish. To prolong the life and keep your outdoor lighting in

good condition, it is recommended that periodically it is cleaned using a soft cloth followed by the application of a light coating of oil, such as WD40.

**Do not clean the units with a pressure washer.**

## Recycling advice



Waste electrical products should not be disposed of with household waste. Please recycle where facilities exist. Check with your Local Authority or retailer for recycling advice.

## Safety information

Live Voltages may be present in the transformer even when turned off or when completely disconnected. For your safety, always switch off the supply before maintaining the system.

**'The LED module of this luminaire is not replaceable, when the LED module reaches its end of life the whole luminaire shall be replaced**

Iss.5 13072018

## Instruction leaflet

# Ikon Pro Outdoor LED Kit

59130, 59131, 59132, 59133, 59134, 59135, 59136, 59137, 59138  
70657, 70658, 70659



saxby  
lighting

Thank you for purchasing this light fitting. Please read the instructions carefully before use to ensure safe and satisfactory operation of this product. Please retain these instructions for future reference.

## Warning

**The power supply is Double Insulated and does not require connection to an Earth circuit.**

**The LED units are Safety Extra Low Voltage and must not be earthed.**

Please read these instructions carefully before commencing any work.

This unit must be fitted by a competent and qualified electrician.

Install in accordance with IEE Wiring regulations and current Building Regulations.

This system operates at Safety Extra Low Voltage (12V), via an LED driver. Never connect the light fittings directly to the mains without using the supplied driver.

The mains plug must be situated indoors (e.g. house, garage, shed) in order to protect it from the elements.

Do not exceed the driver load. The supplied driver with items 59130-59137 & 70657-70659 can operate up to

a maximum of 20 LED heads. For 59138, the supplied driver can operate up to a maximum of 10 LED heads.

Always disconnect the plug from the mains when installing or maintaining this system.

This system contains non-replaceable parts and cannot be serviced. If damage occurs the part should be scrapped.

This product cannot be dimmed.

The LED heads and driver are rated at IP67. They are suitable for installation in very wet areas, but must not be permanently submerged.

The driver must not be installed directly in the soil.

Waste electrical products should not be disposed of with household waste. Please recycle where facilities exist. Check with your local authority or retailer for recycling advice.

Rated maximum surface temperature is 80°C.

## Specification

The Kit contains:

- 1 x IP67 rated driver with 3 metres of mains cable and mains plug.
- 1 x 5m extension cable
- 2 x 5 LED head looms (total length 7.5m per loom)
- 12 x end plug

Power Supply: 220-240V 50Hz. Output: 12V DC 15W Max. Constant voltage

Lamp: 59130, 59131, 59132 Ikon Pro 25mm, 35mm, 45mm - Cool white 70657: Ikon Pro 25mm - Warm White  
59133, 59134, 59135 Ikon Pro 25mm, 35mm, 45mm - Blue 70658: Ikon Pro 35mm - Warm White  
59136, 59137, 59138 Ikon Pro 25mm, 35mm, 45mm - RGB 70659: Ikon Pro 45mm - Warm White

IP rating: 67

## Layout

- Plan the desired layout of these fittings carefully, ensuring the cables will reach the distances between the mains plug, the LED driver and each light fitting.
- Avoid locating any cables in positions that would cause a trip hazard. Position cables and driver away from areas where they may be at risk from being cut, trapped or damaged.
- The mains plug must be situated indoors. The kit can be wired into a IP67 external terminal block. This must be carried out by a competent and qualified electrician.
- The driver and LED head units are rated at IP67 and

can be positioned outdoors.

- On RGB kits, the driver and remote control receiver are combined into one unit. The remote control operates via Radio Frequency (RF) so to ensure efficient operation, position the receiver unit appropriately.
- These fittings should not be installed/mounted in concrete and should only be mounted in vertical surfaces (only horizontally mounted).
- A PIR sensor (71553) and photocell sensor (71554) are available to purchase separately for this kit. They are not suitable for the RGB kits (59136-59138).

## Installation

The Ikon Pro LED kit has been specifically designed for use in decking and combines some innovative features to make installation easier. 2x prewired looms each with 5 LED heads plus a 5m extension cable allow longer runs to be achieved. Wiring loom can be fitted into the deck during construction. Heads are interchangeable allowing different sizes and colours to be operated from one power source.

1. Position the plug next to the indoor mains outlet socket that the system will connect to. Do not plug-in at this stage.
2. After deciding the layout of the light fittings, ensure the cables are long enough to connect to the desired positions. The maximum distance between heads is 1.5m.
3. Drill the mounting holes for the light units taking care not to damage any pipes or mains cables beneath the mounting surface. Minimum hole depth is 80mm. Cutter hole sizes are as follows:-  
- 25mm diameter lights = 20mm cutter hole  
- 35mm diameter lights = 25mm cutter hole  
- 45mm diameter lights = 32mm cutter hole

4. From underneath the decking, feed the head unit and cable up through each installation hole. (A).
5. Fit the protective cap onto the head unit - to prevent the unit from dropping back through the holes and to keep debris out. (B).
6. Once the decking has been fully assembled and the lights are ready to be installed, remove the protective cap and push the LED unit onto the head unit observing the correct polarity (align the flat part of the connector to ensure correct connection). (C)
7. Fit the assembled head units into the holes by pushing into the hole. The springs on the side of the head will secure the head units in place. (D)
8. Connect all looms together and connect directly to the driver output cable, or the extension cable.
9. Ensure any unused heads and cable ends are fitted with the end plug and protective cap to prevent the ingress of moisture.
10. Plug the mains plug into the socket and switch on to test.

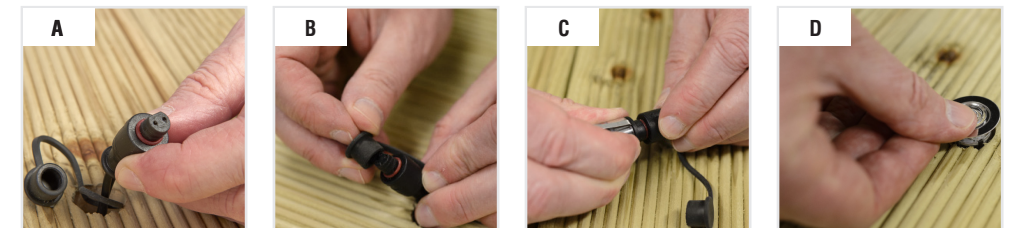

### Kit Layout Diagram

