

syncbox

Guide

Included within:
Dry wall

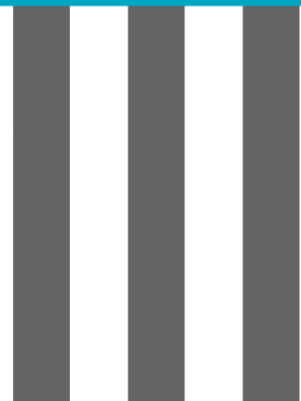

Dry Wall

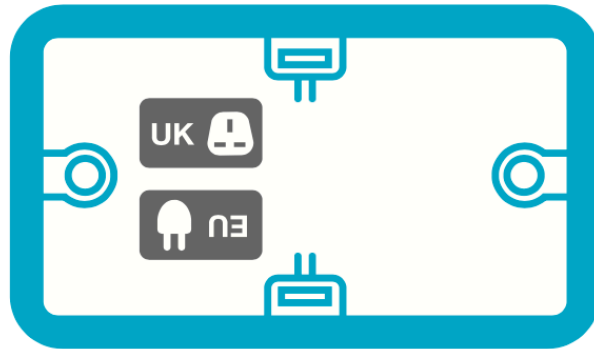

Don't remove flange
(flange is required)

1

Dry Wall

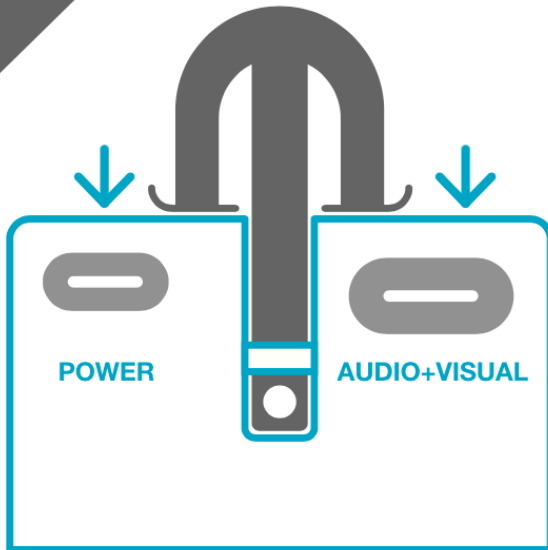

Insert straps to correct position
(don't push all the way)

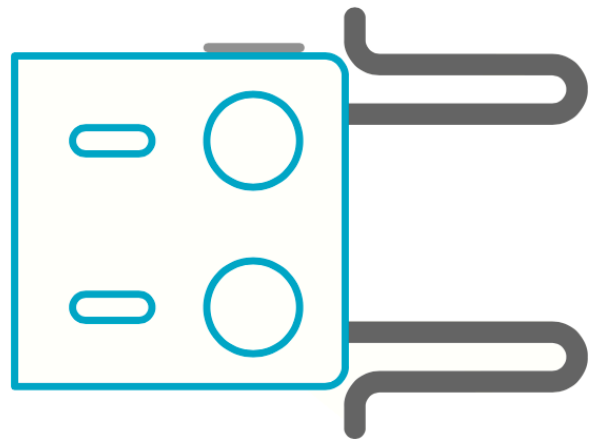

2

Dry Wall

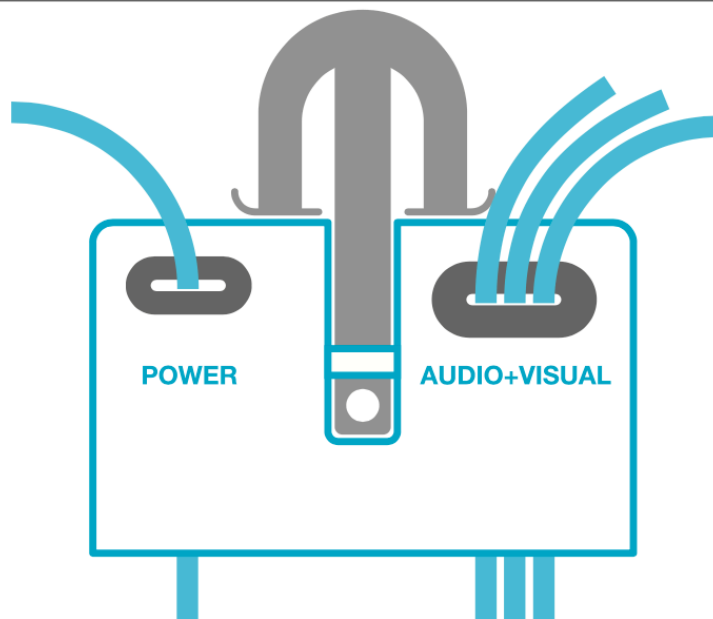

Insert cabling into
designated entries

3

Dry Wall

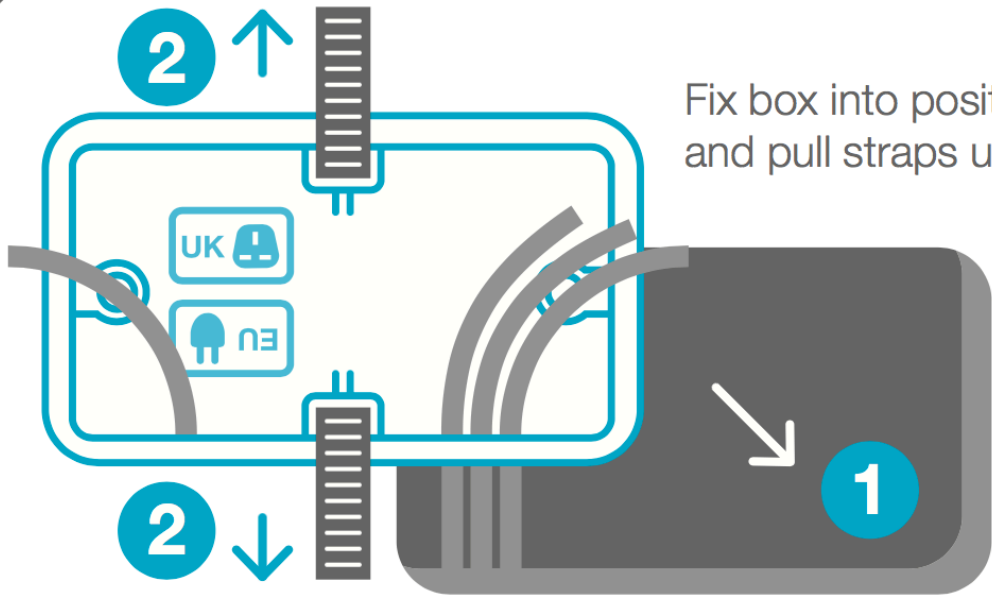

Fix box into position and pull straps until firm

4

Dry Wall

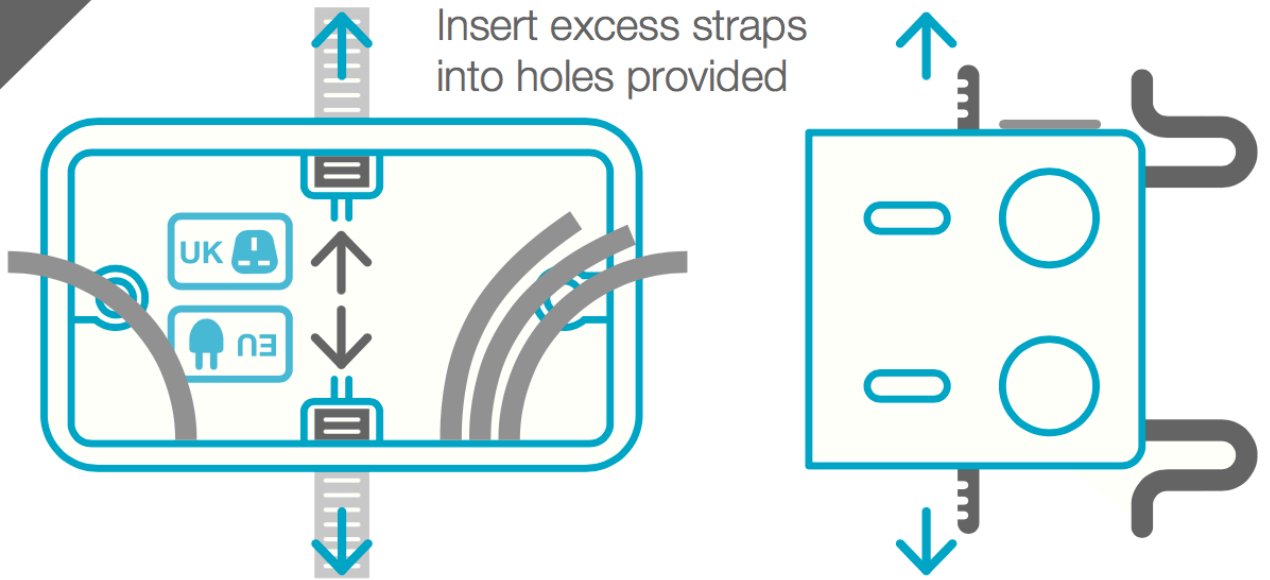

Insert excess straps into holes provided

5

Dry Wall

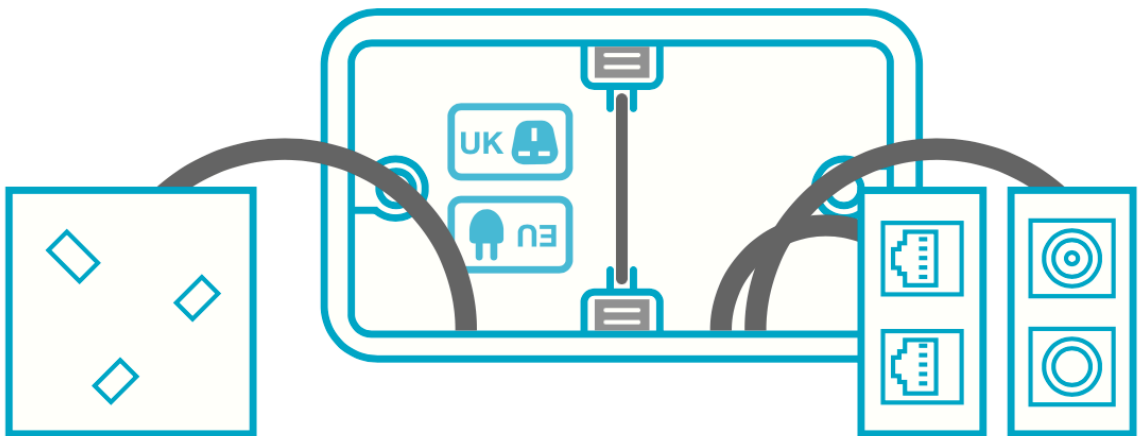

6

Dry Wall

Click modules into frames
(use power divider if required)

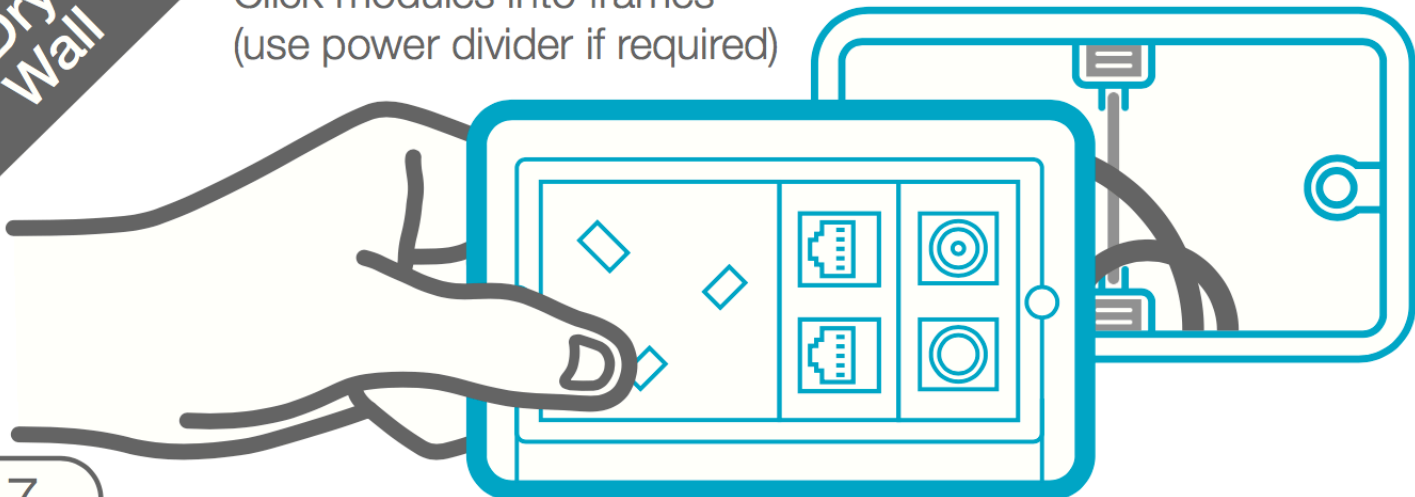

7

Dry Wall

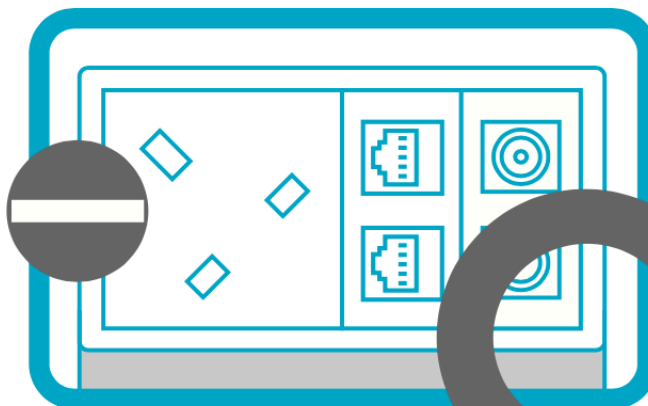

Screw frame into position

8

Dry Wall

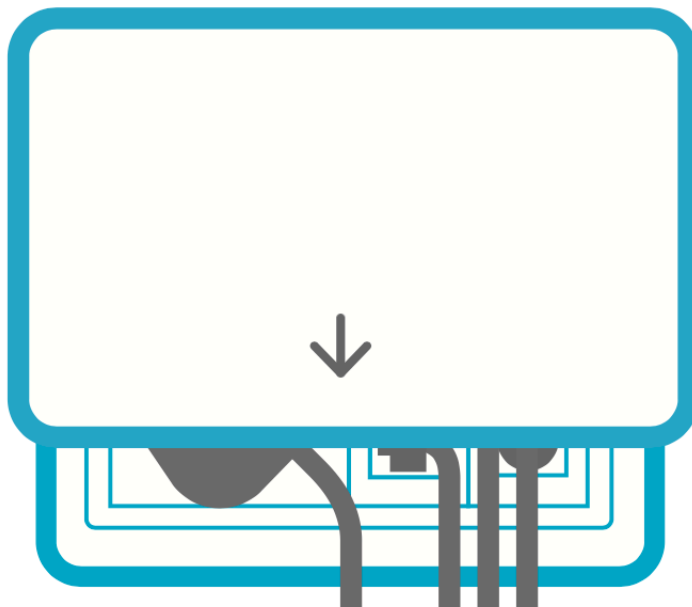

Cable and cover

9