

Ceiling Masking Plate

Model: Ei1516

For use with Ei160 series Easi-Fit mounting plate and/or Ei168 Radiolink Base. The Ceiling Masking Plate hides the footprint of the Ei157 pattress on the ceiling, when replacing Ei150 series smoke alarms with Ei160 series alarms.

Instructions

1. Remove the wiring cover on the Ei160 Easi-fit mounting plate or Ei168 Radiolink base. If surface trunking will be used for the wiring, also remove the trunking door.
 2. Peel off the liners from the 2 areas with double-sided tape on the front of the Ei1516 Ceiling Masking Plate.
 3. Line up the wiring hole cut out in the foam gasket of the Ei160 Easi-fit mounting plate or Ei168 Radiolink base with the cut out in the Ei1516 Ceiling Masking Plate. (See Figure. 1)
 4. Press the 2 together so that the Ei1516 Ceiling Masking Plate is now adhered to the rear of Ei160 Easi-fit mounting plate or Ei168 Radiolink base. They should be fixed together and concentric.
 5. If they are not concentric, pull the 2 plates apart and repeat steps 3 and 4 again.
 6. Orientate the Ei160 Easi-fit mounting plate or Ei168 Radiolink base on the ceiling in a way that the Ei1516 Ceiling Masking Plate fixed to it will cover the footprint of the previously installed Ei157 pattress. Continue to install the Ei160 Easi-fit mounting plate or Ei168 Radiolink base as usual by following the instructions described in its use & care manual.
- Note:** Take care not to excessively tighten the screws when fixing the Ei160 mounting plate or Ei168 Radiolink base to the ceiling. This may distort it, making it difficult to slide the smoke/heat alarm on.

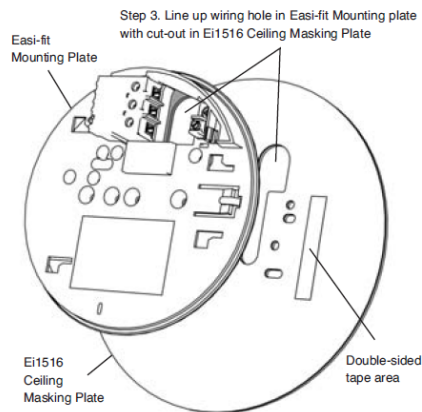

Figure 1

Ei Electronics, Shannon, Co. Clare, Ireland www.eielectronics.com
Aico Ltd, Oswestry, Shropshire, UK. Tel: 08707584000 www.aico.co.uk

P/N A16291
Rev0

Ceiling Masking Plate

Model: Ei1516

For use with Ei160 series Easi-Fit mounting plate and/or Ei168 Radiolink Base. The Ceiling Masking Plate hides the footprint of the Ei157 pattress on the ceiling, when replacing Ei150 series smoke alarms with Ei160 series alarms.

Instructions

1. Remove the wiring cover on the Ei160 Easi-fit mounting plate or Ei168 Radiolink base. If surface trunking will be used for the wiring, also remove the trunking door.
 2. Peel off the liners from the 2 areas with double-sided tape on the front of the Ei1516 Ceiling Masking Plate.
 3. Line up the wiring hole cut out in the foam gasket of the Ei160 Easi-fit mounting plate or Ei168 Radiolink base with the cut out in the Ei1516 Ceiling Masking Plate. (See Figure. 1)
 4. Press the 2 together so that the Ei1516 Ceiling Masking Plate is now adhered to the rear of Ei160 Easi-fit mounting plate or Ei168 Radiolink base. They should be fixed together and concentric.
 5. If they are not concentric, pull the 2 plates apart and repeat steps 3 and 4 again.
 6. Orientate the Ei160 Easi-fit mounting plate or Ei168 Radiolink base on the ceiling in a way that the Ei1516 Ceiling Masking Plate fixed to it will cover the footprint of the previously installed Ei157 pattress. Continue to install the Ei160 Easi-fit mounting plate or Ei168 Radiolink base as usual by following the instructions described in its use & care manual.
- Note:** Take care not to excessively tighten the screws when fixing the Ei160 mounting plate or Ei168 Radiolink base to the ceiling. This may distort it, making it difficult to slide the smoke/heat alarm on.

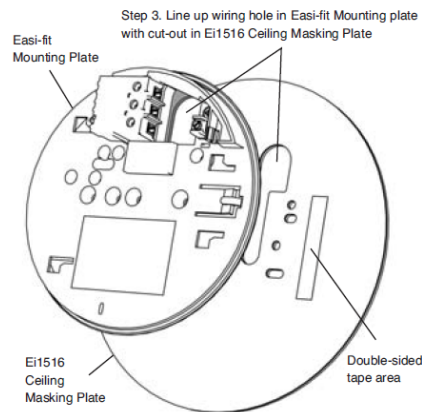

Figure 1

Ei Electronics, Shannon, Co. Clare, Ireland www.eielectronics.com
Aico Ltd, Oswestry, Shropshire, UK. Tel: 08707584000 www.aico.co.uk

P/N A16291
Rev0